

playmobil®

5475



**WARNING:
CHOKING HAZARD**

Small parts. Not for children under 3 years.

"Ne concerne que les USA"

Wichtige Unterlagen, bitte sorgfältig aufbewahren!
Important: Please keep these instructions for future reference!
Documents importants, à conserver soigneusement!
Belangrijke documenten, bewaar deze zorgvuldig!



1

1

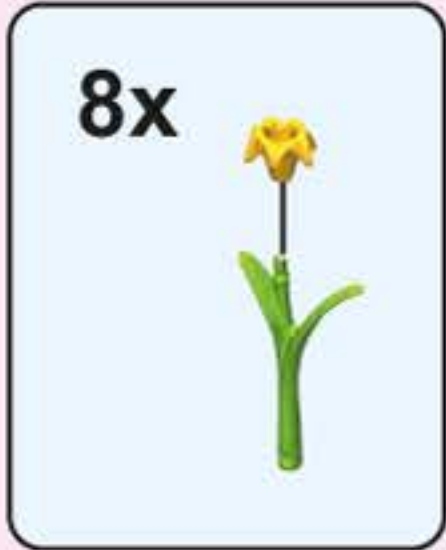

2

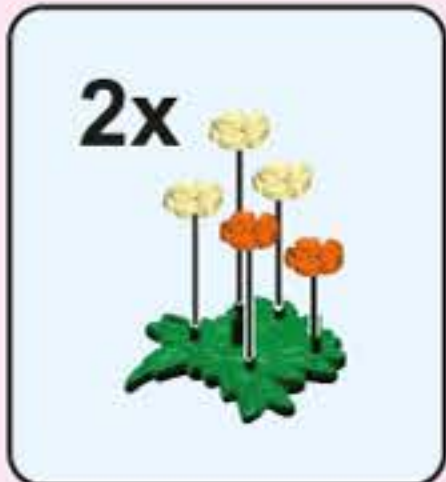

2

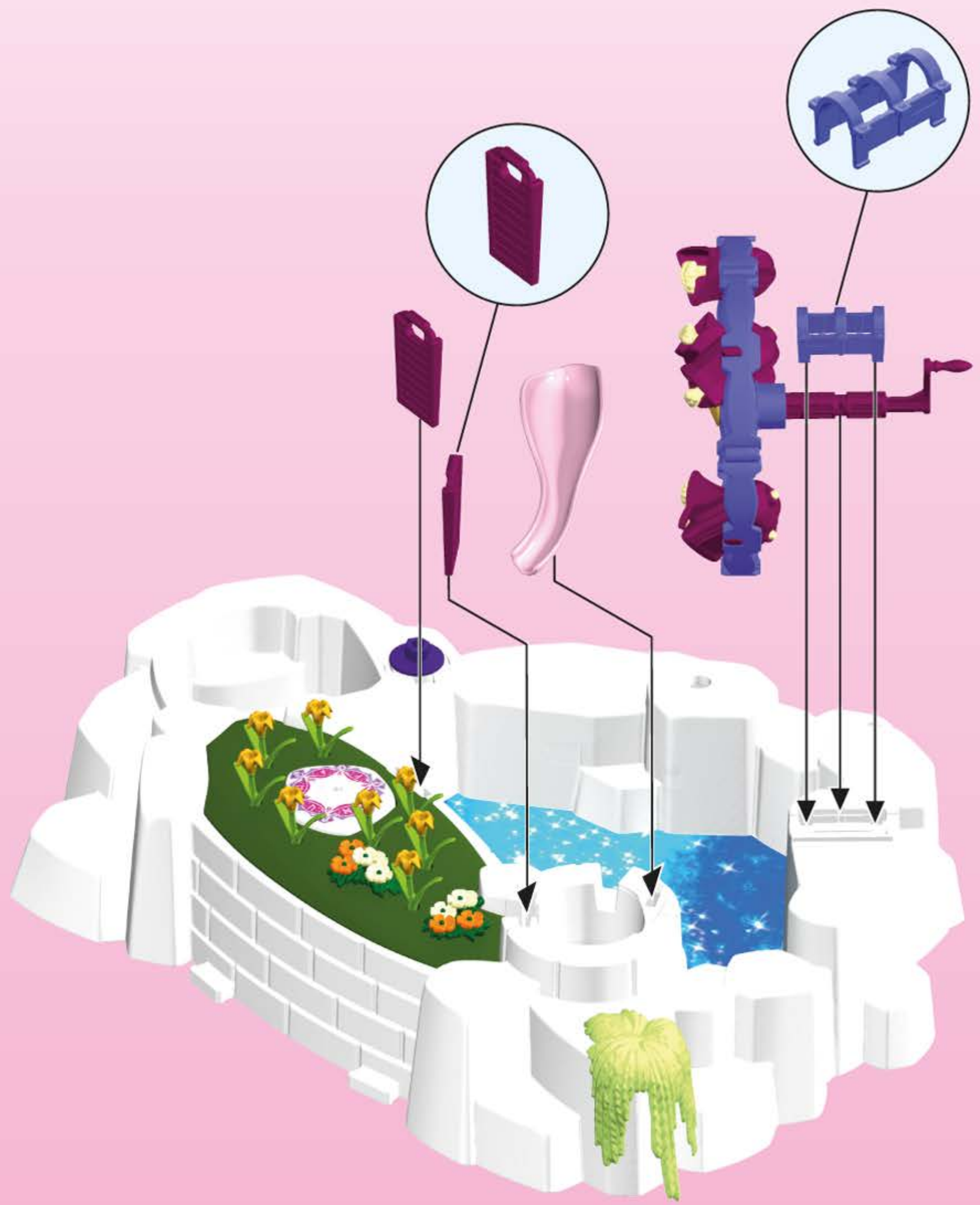
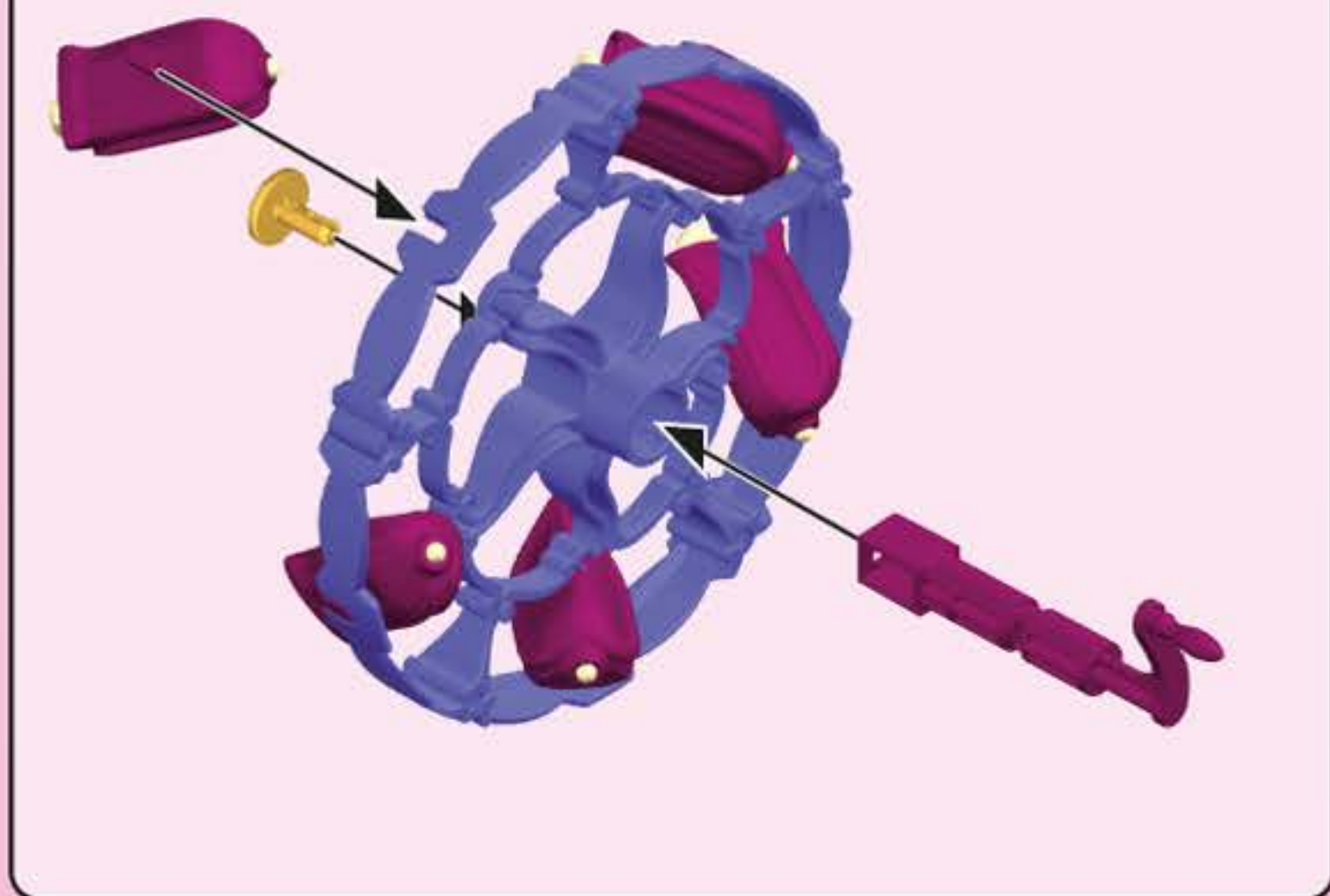
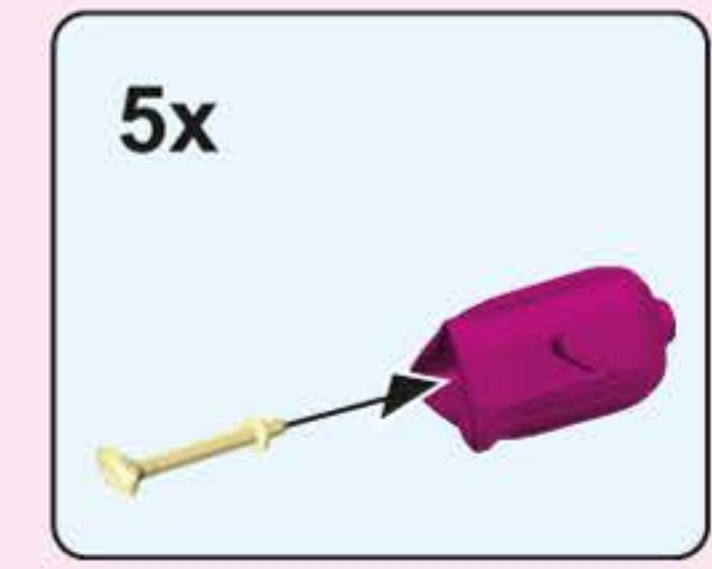

3

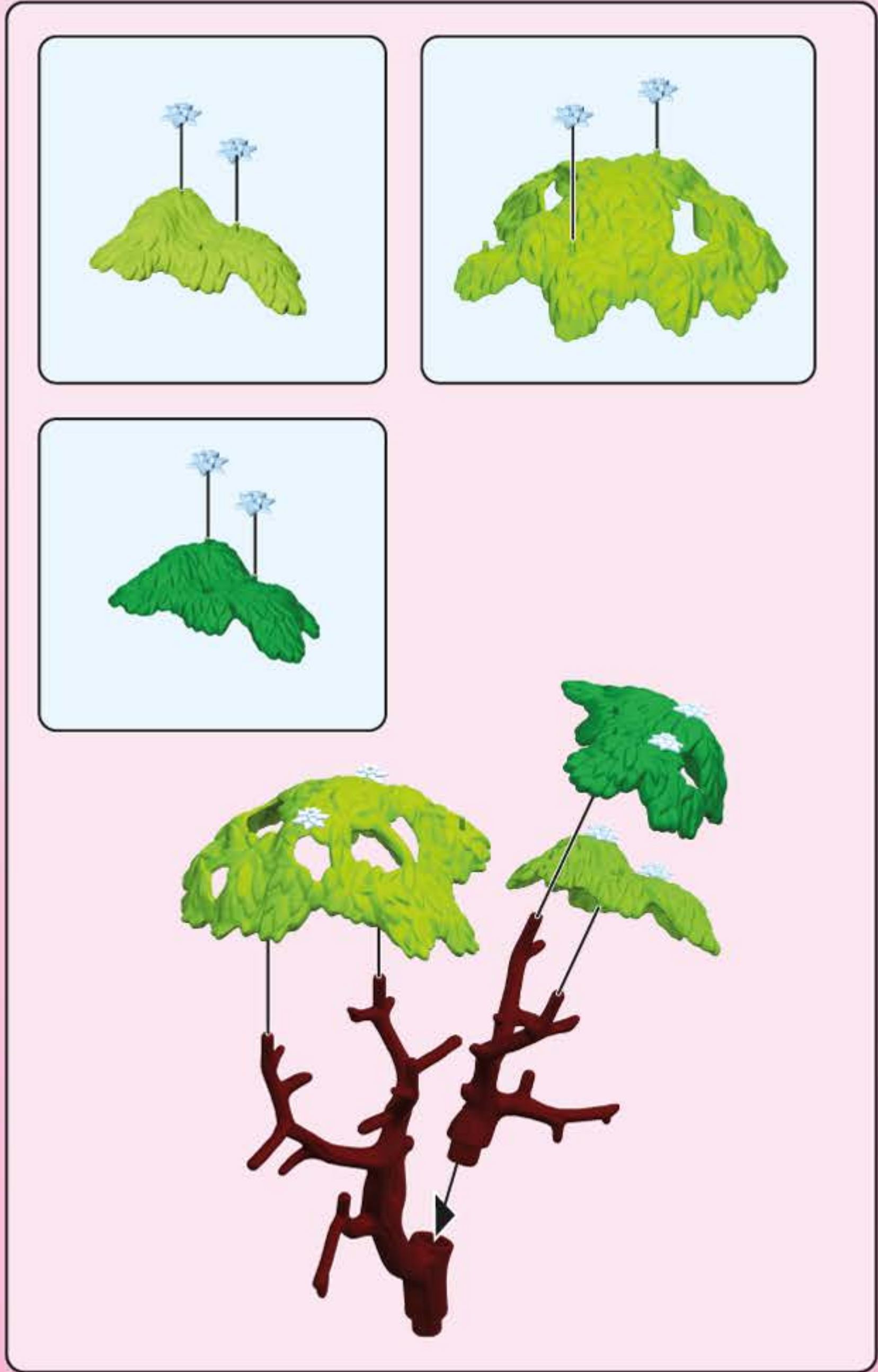

4

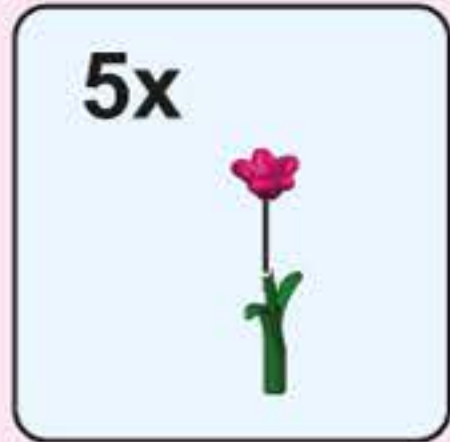
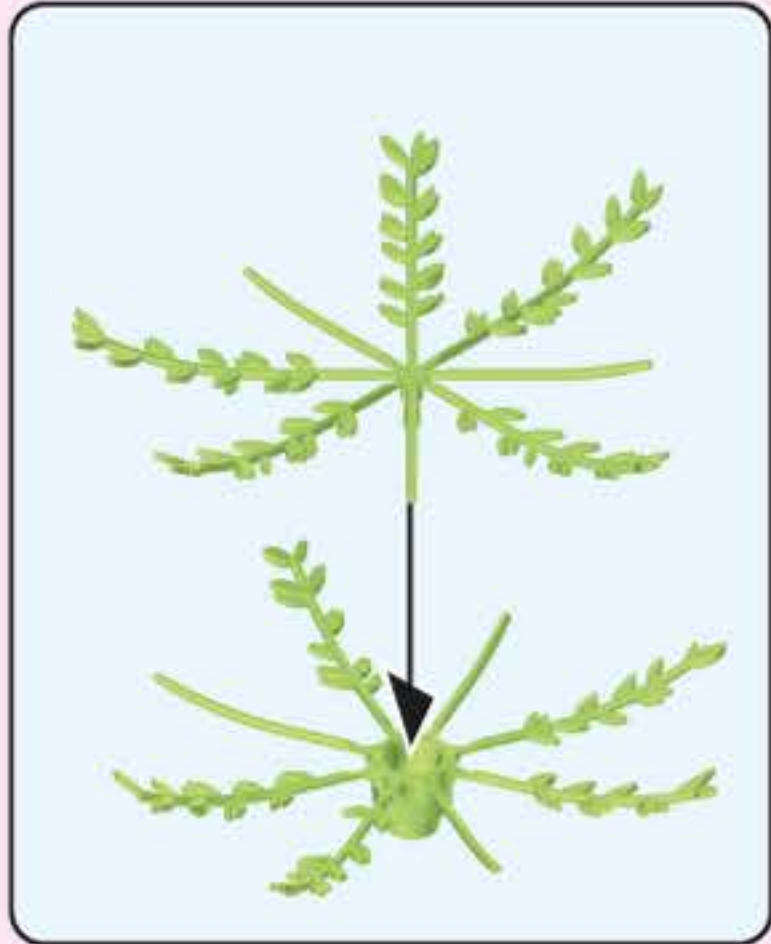

5

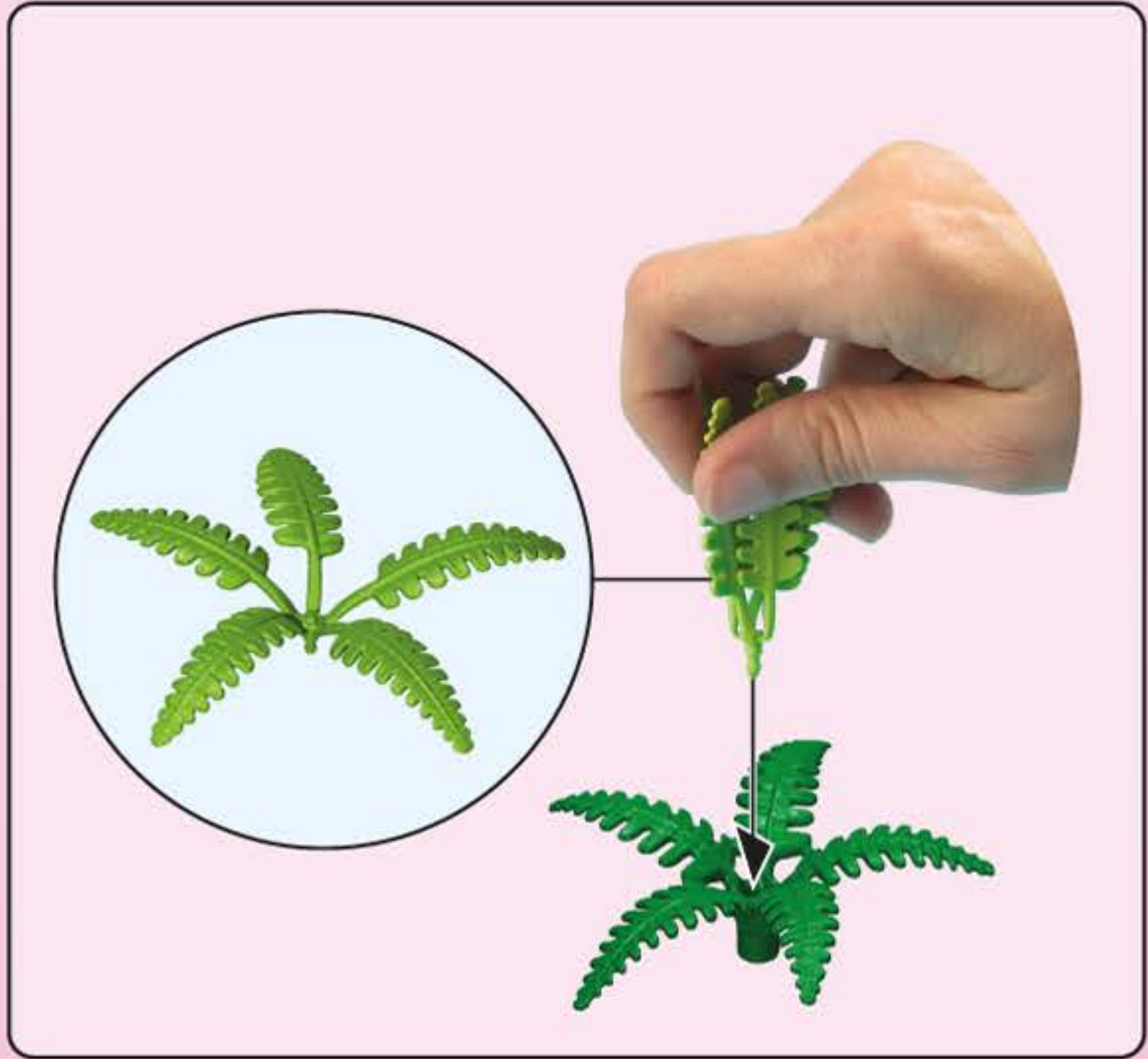

6

(D A CH L B) Nur Trinkwasser verwenden. Nach dem Spielen austrocknen lassen.

(USA GB CDN M IRL) Use only tap water. Dry thoroughly after play.

(F CDN B L CH) N'utiliser que de l'eau potable. Faire sécher après chaque utilisation.

(E MEX) Utilizar solamente agua potable. Dejar secar antes de guardar.

(NL B) Enkel drinkbaar water gebruiken. Na het spelen laten drogen.

(I CH) Usare solo acqua potabile. Asciugare bene dopo ogni uso.

(P) Utilizar somente água potável. Deixar secar antes de guardar.

(DK) Anvend kun drikkevand. Lad det tørre ud når du er færdig med at lege.

(N) Kun drikkevann skal benyttes. Tørk opp etter at leken er ferdig.

(S FIN) Använd endast dricksvatten. Låt torka efter användandet.

(FIN) Käytä ainoastaan juomavettä. Anna kuivua leikin jälkeen.

(H) Kérjük kizárólag ivóvizet használgjon! Játék után ajánlott a termék kiszáritása!

(CZ) Používat jen pitnou vodu. Po hraní nechat vyschnout.

(EST) Kasutada üksnes joogivett! Mängimise järel kuivatada!

(LV) Izmantot tikai dzeramo ūdeni. Pēc spēlēšanās ļaut nožūt.

(LT) Naudokite tik geriamąjį vandenį. Pažaidus, išdžiovinkite.

(SLO) V igračo vlivajte le pitno vodo. Po igri naj se igrača posuši.

(SK) Používať iba pitnú vodu. Po hre nechať vyschnúť.

(PL) Używaj tylko wodę pitną. Po zabawie pozostaw do wyschnięcia.

(TR CY) Sadece içme suyu kullanınız. Oyundan sonra kurumaya bırakın.

(GR CY) Χρησιμοποιείτε μόνο νερό βρύσης. Μόλις τελειώσετε, αφήστε το παιχνίδι να στεγνώσει εντελώς.

(RO) Se folosește doar apă potabilă. După joacă se lasă să se usuce.

(BG) Използвайте само питейна вода. След игра оставете да изсъхне.

(CN) 仅使用饮用水。玩耍后要干燥。



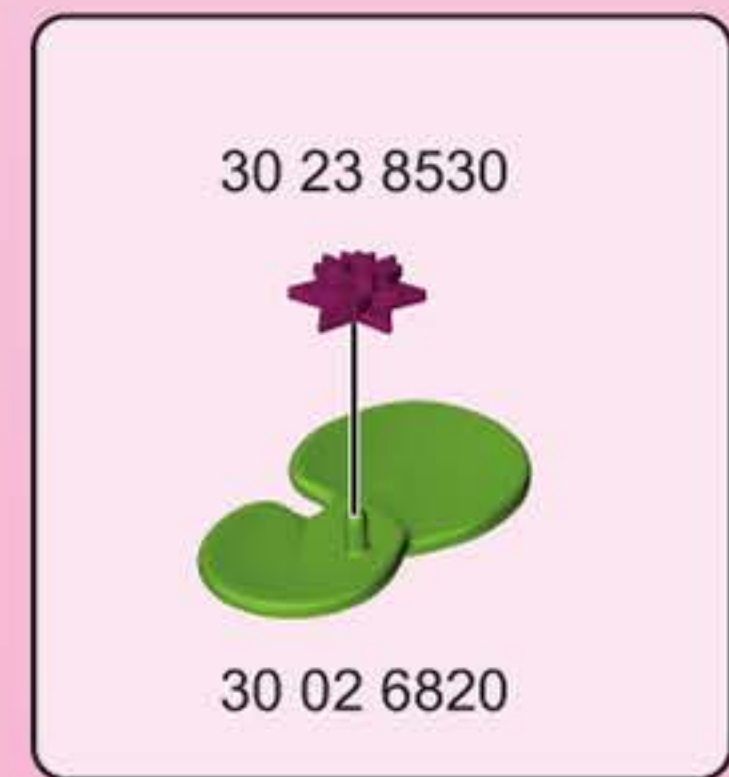
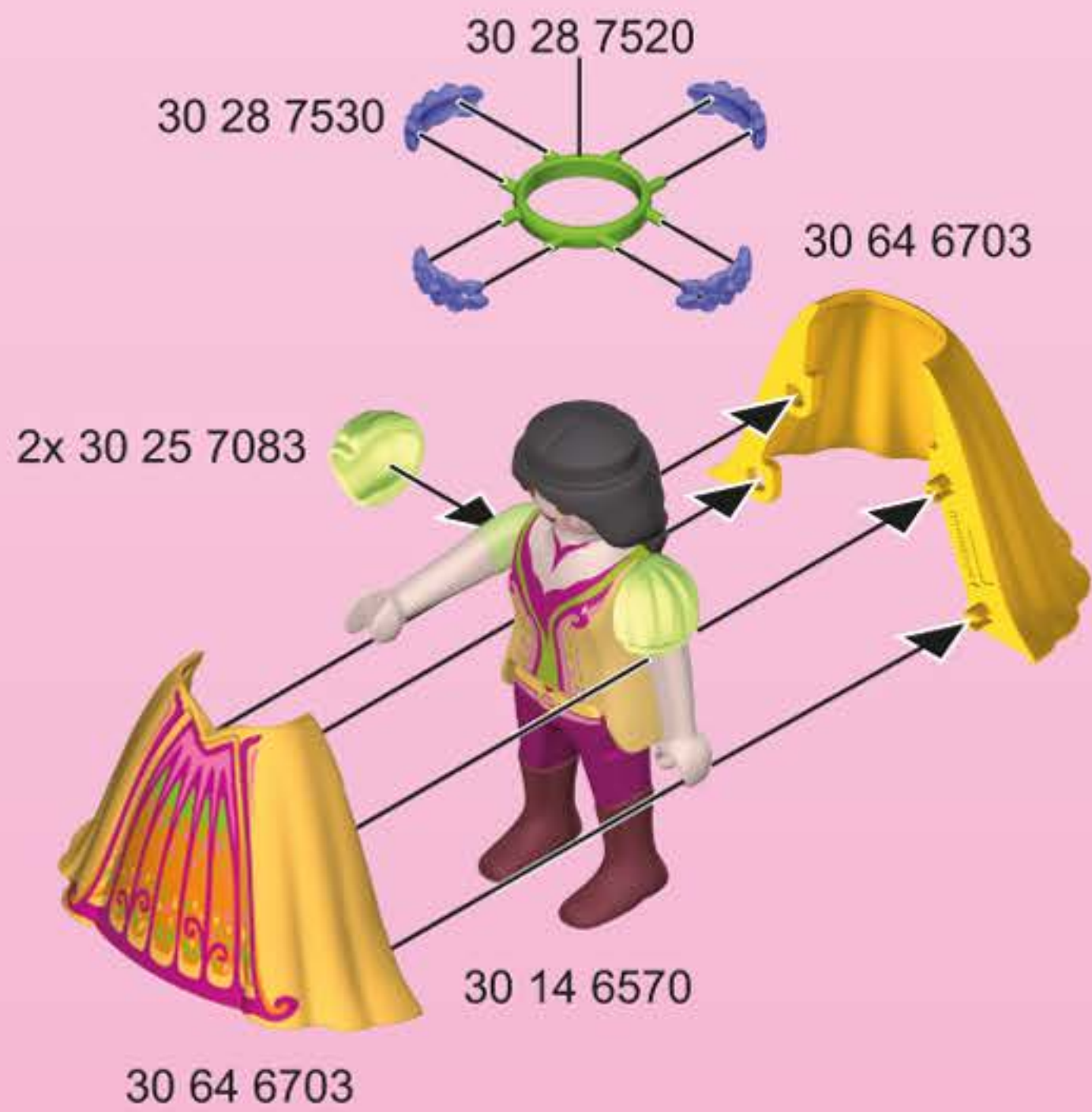
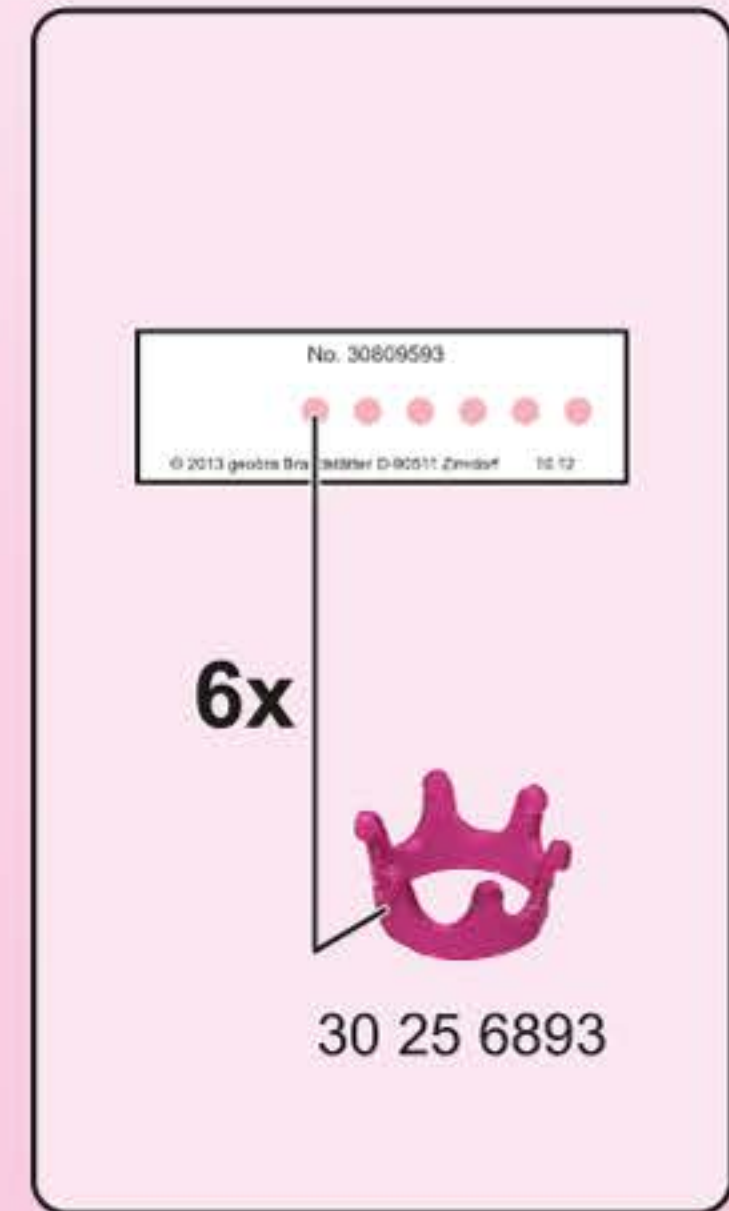
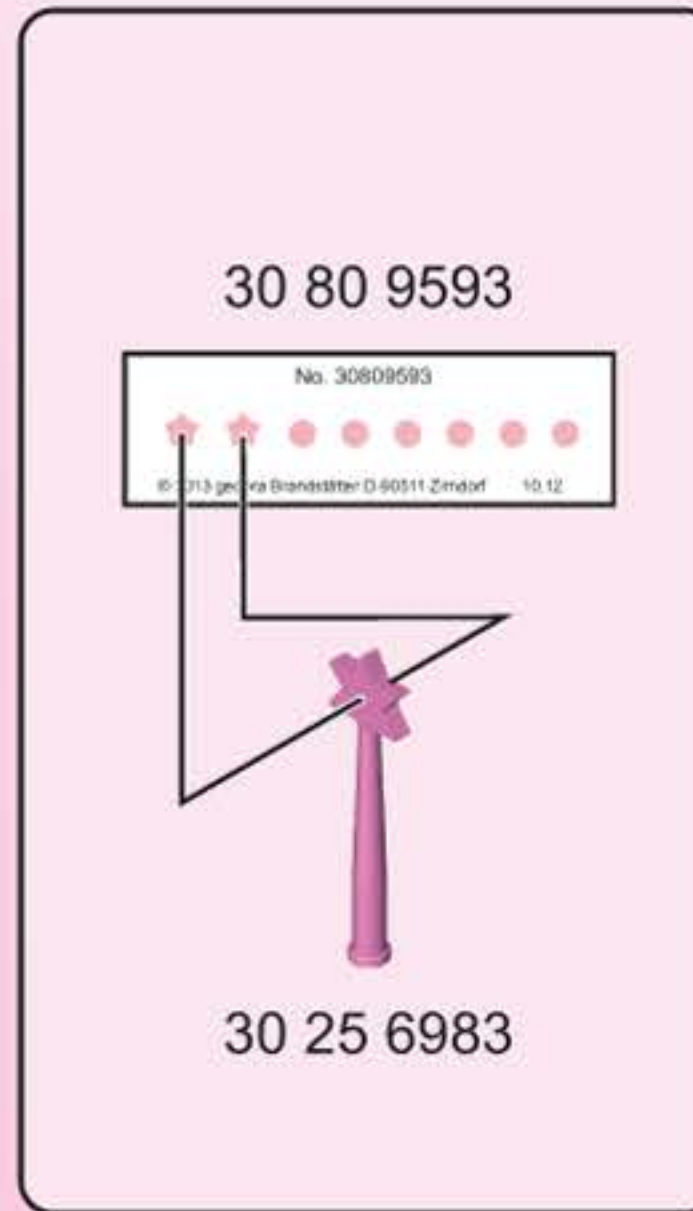
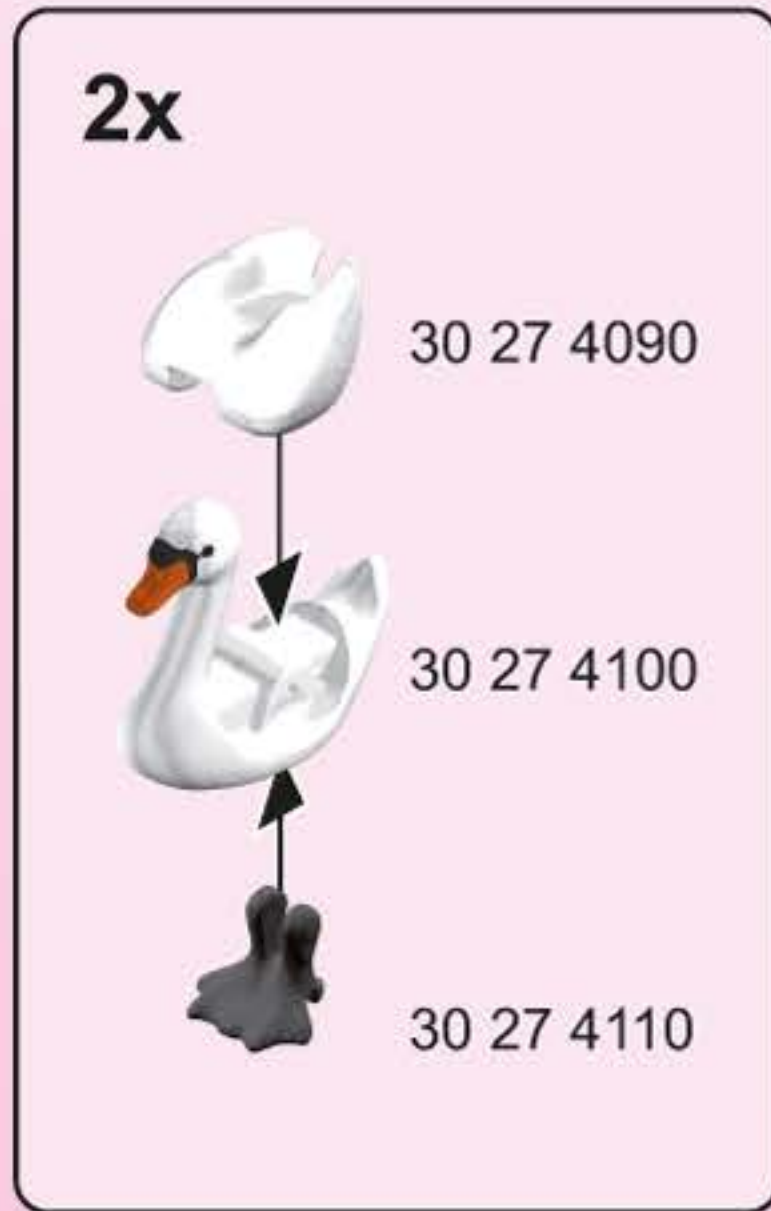
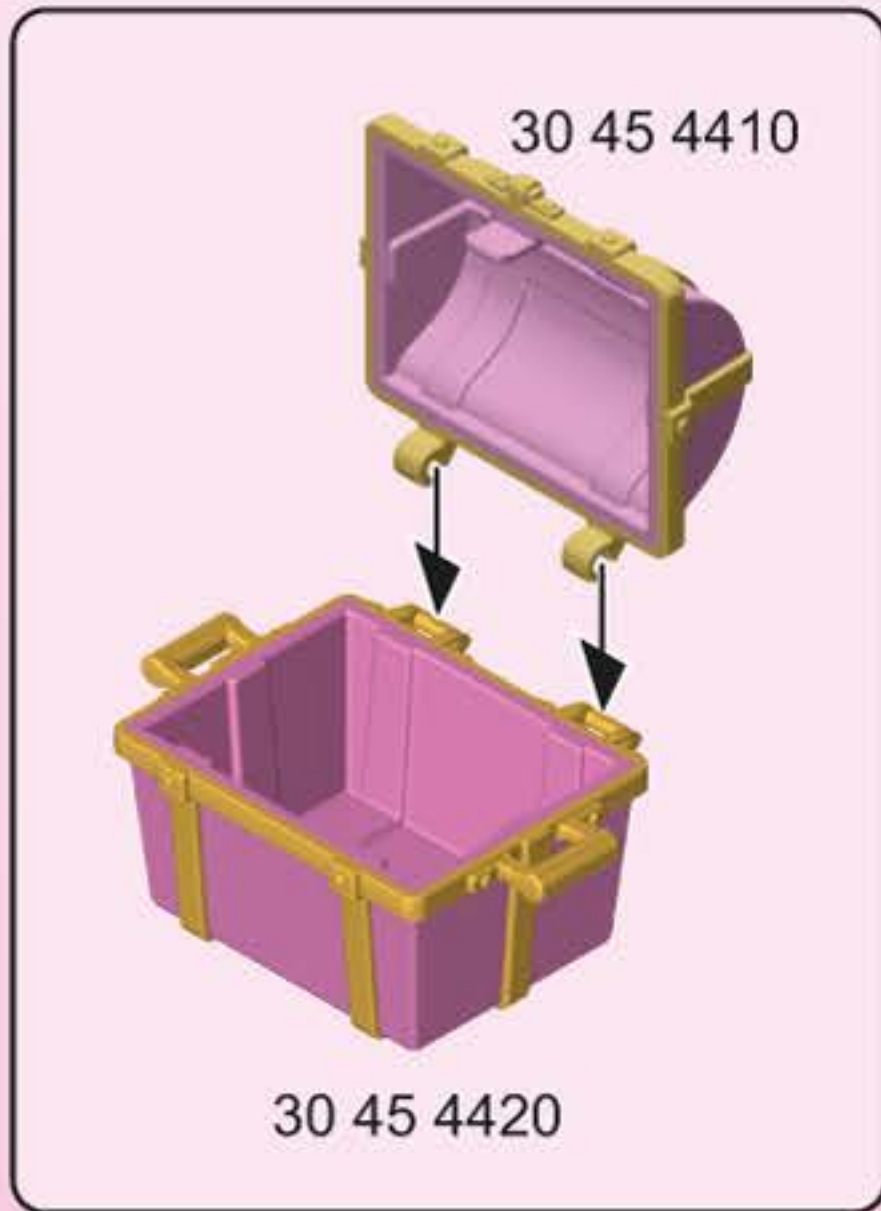

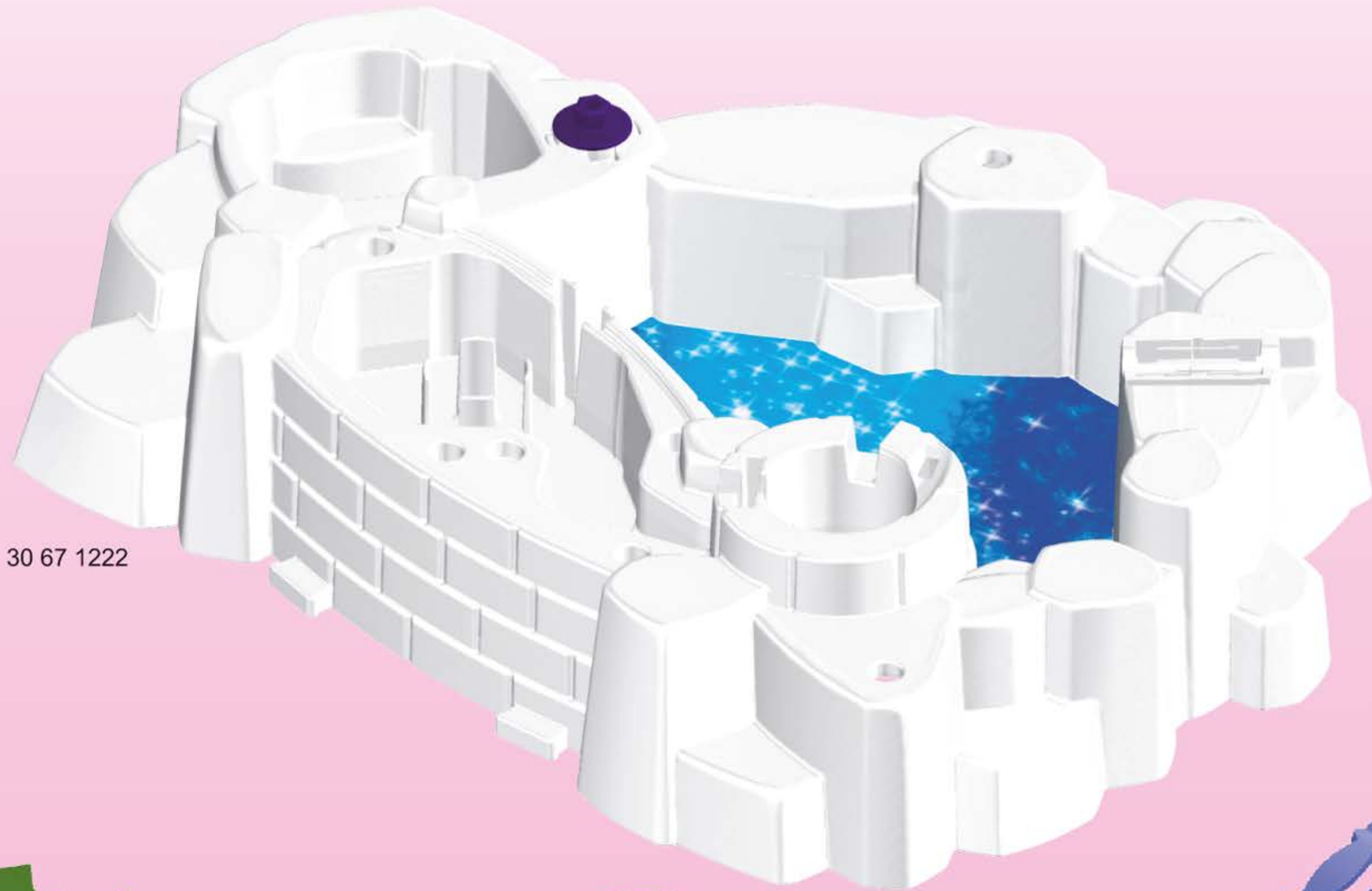

30 67 1222

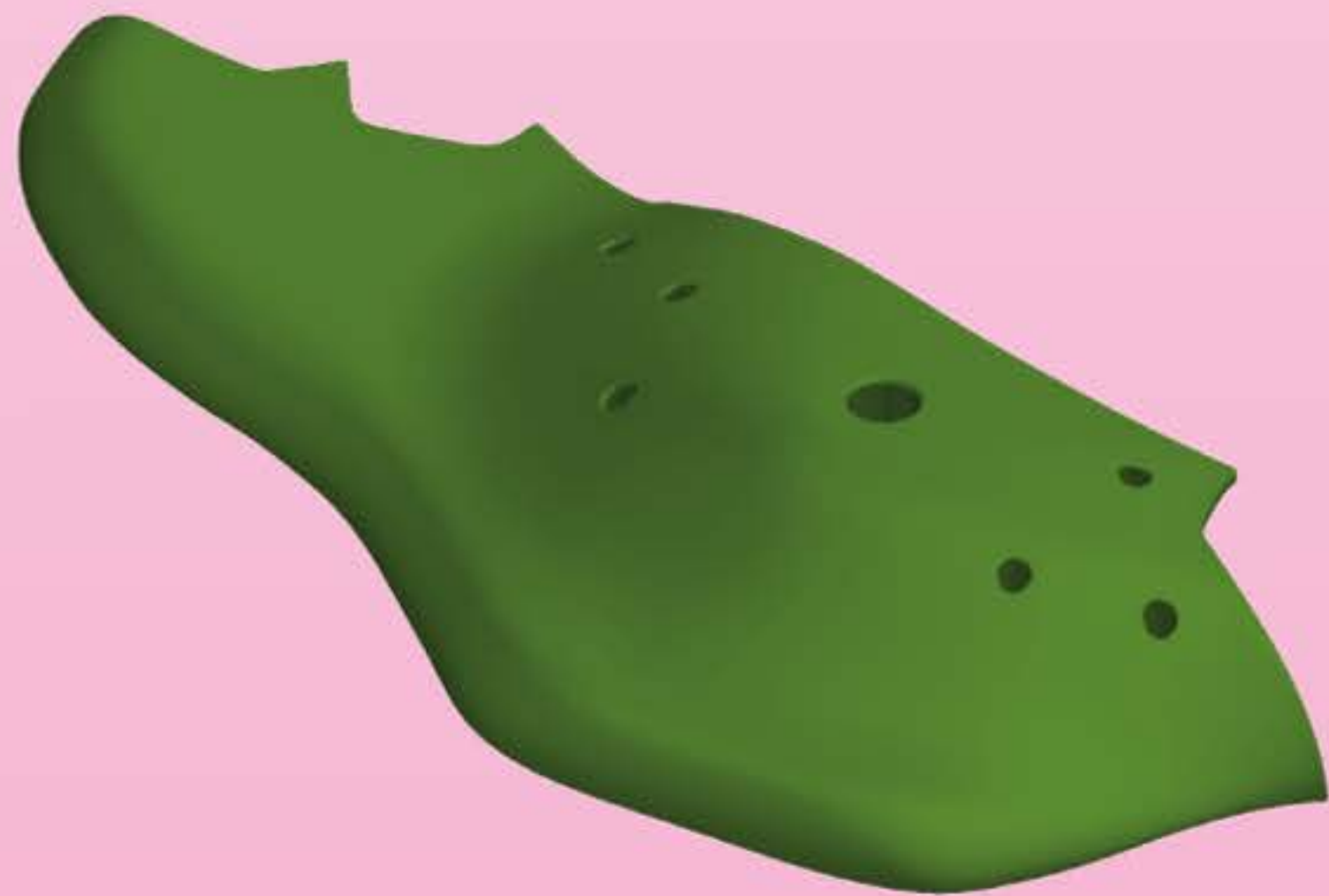

30 46 0372



30 46 0792



30 25 7143

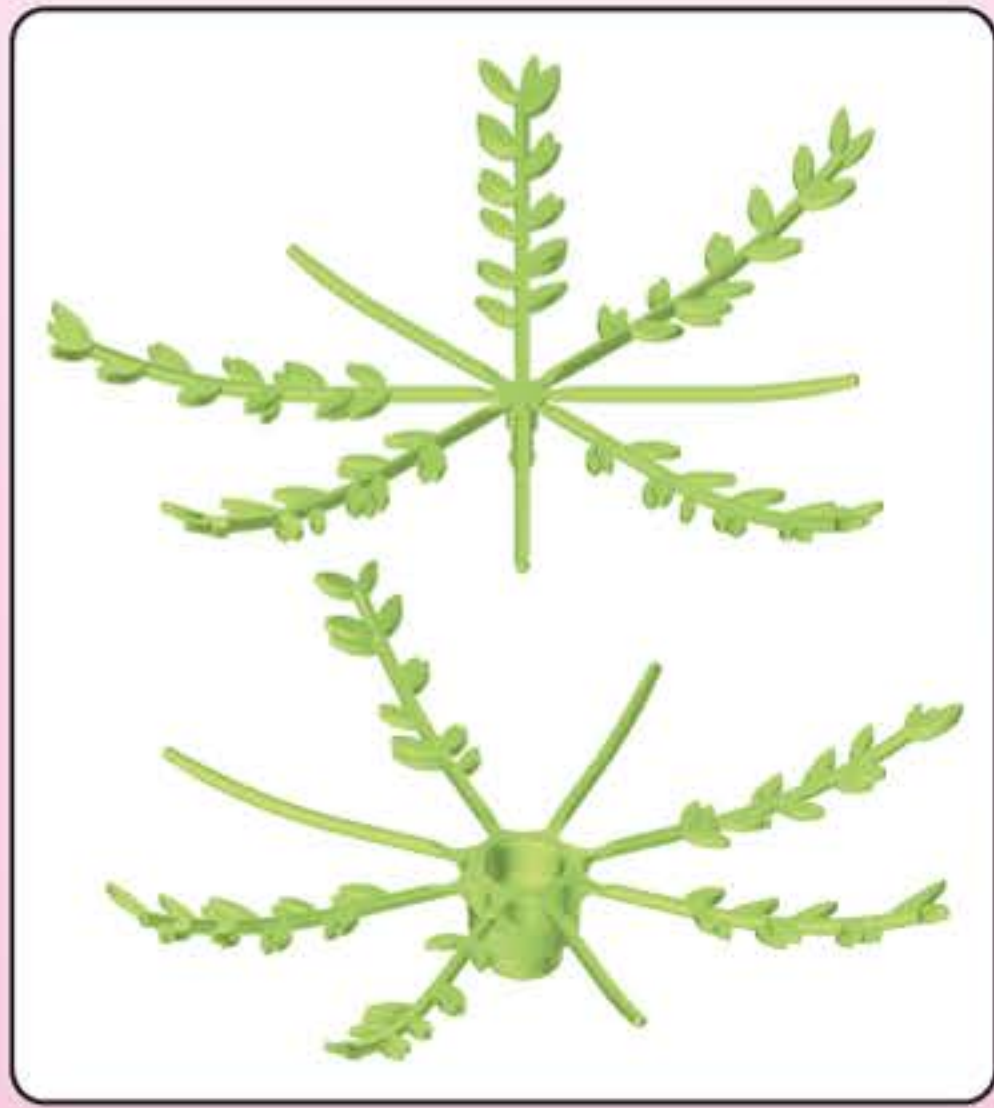

30 51 2622



30 20 8012



30 20 8022



30 25 7163



30 20 6080



30 67 1202



30 64 6743



30 02 6460



30 07 9710



30 22 7780



30 02 4260



30 02 3900



30 25 7153



2x 30 25 7173



2x 30 25 6993



30 25 7103



30 64 6733



5x 30 25 7123



30 63 4963



30 64 4172



8x 30 25 0620



8x 30 25 0580



3x 30 23 8422



30 62 7663



5x 30 25 7133



5x 30 02 4320



30 71 9872

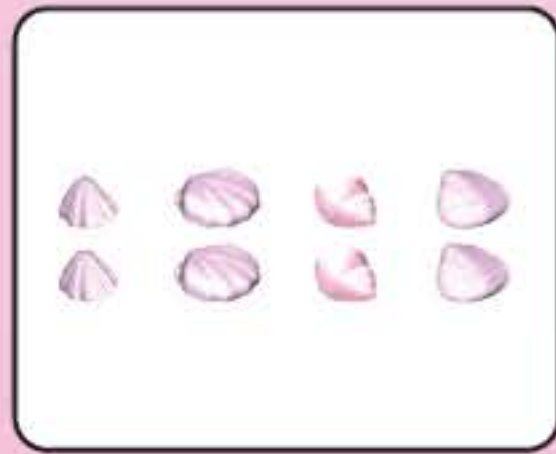

30 51 6070



30 67 9460



30 25 7113



30 02 6640



3x 30 27 4130



6x 30 20 4460



8x 30 24 9220



7x 30 24 9230



8x 30 20 3920



6x 30 25 8710



3x 30 25 7023

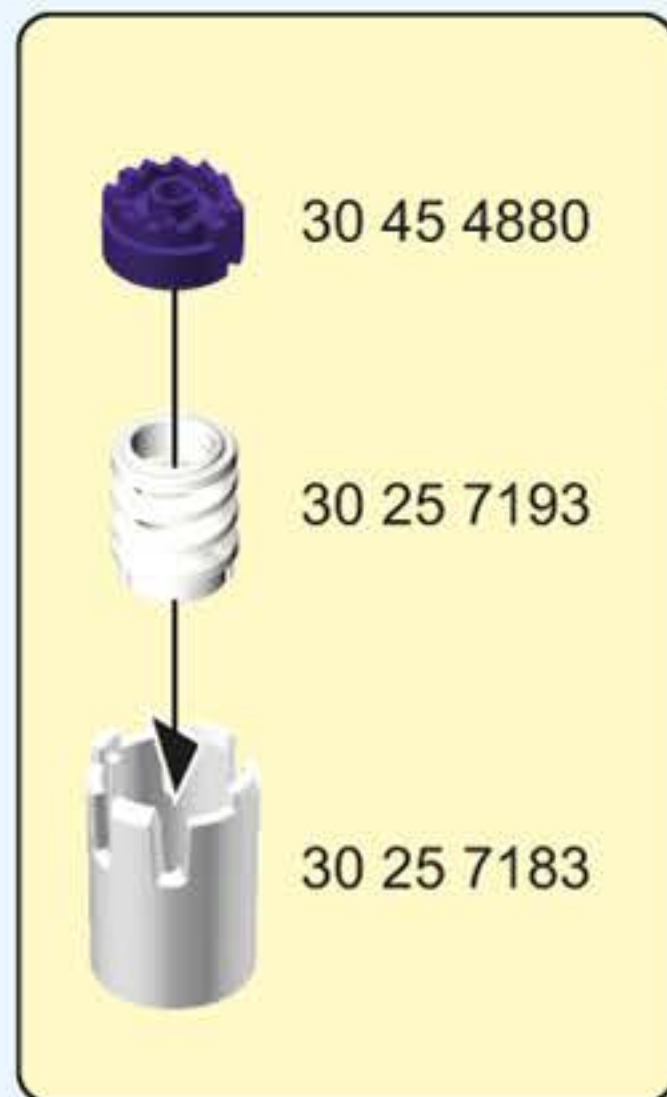
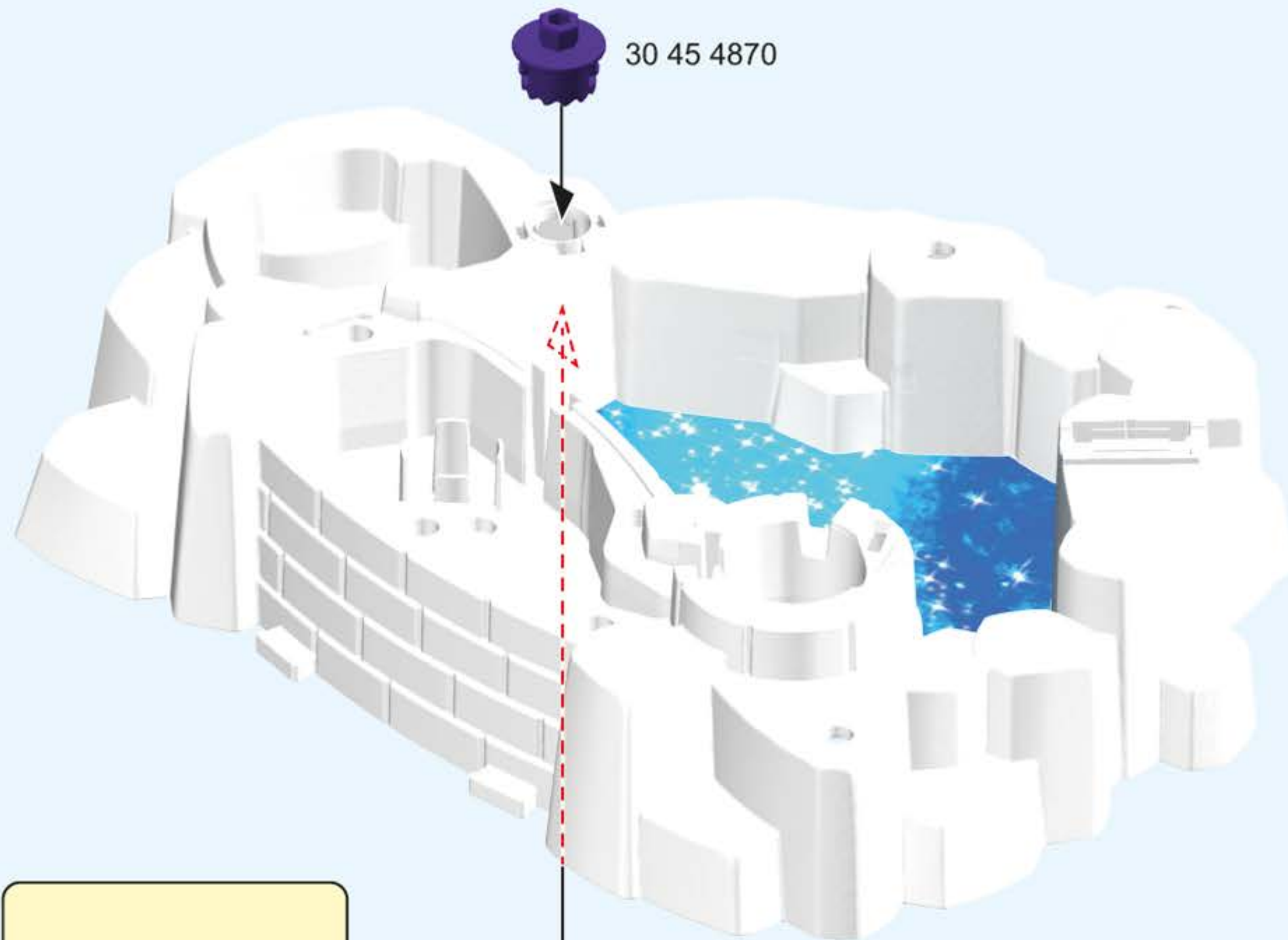

Serviceadressen finden Sie in allen Playmobil-Prospekten

Addresses of Customer Service Departments are shown in all Playmobil catalogues

L'adresse du service consommateurs est indiquée dans tous les catalogues Playmobil

Troverete gli indirizzi dei centri di assistenza in tutti i cataloghi Playmobil

In alle PLAYMOBIL catalogi vindt u het adres van onze klantendienst.

Las Direcciones de los Departamentos de Servicio al Consumidor se encuentran en todos los catálogos Playmobil

Η διεύθυνση του Γραφείου Εξυπηρέτησης Καταναλωτών PLAYMOBIL βρίσκεται σε όλους τους καταλόγους PLAYMOBIL.

pronounce: plāy-mō-bēēl