

playmobil®

5432



**WARNING:
CHOKING HAZARD**

Contains a small ball and small parts.
Not for children under 3 years.

"Ne concerne que les USA"

Wichtige Unterlagen, bitte sorgfältig aufbewahren!
Important: Please keep these instructions for future reference!
Documents importants, à conserver soigneusement!
Belangrijke documenten, bewaar deze zorgvuldig!



Serviceadressen finden Sie in allen Playmobil-Prospekten

Addresses of Customer Service Departments are shown in all Playmobil catalogues

L'adresse du service consommateurs est indiquée dans tous les catalogues Playmobil

Troverete gli indirizzi dei centri di assistenza in tutti i cataloghi Playmobil

In alle PLAYMOBIL catalogi vindt u het adres van onze klantendienst.

Las Direcciones de los Departamentos de Servicio al Consumidor se encuentran en todos los catálogos Playmobil

Η διεύθυνση του Γραφείου Εξυπηρέτησης Καταναλωτών PLAYMOBIL βρίσκεται σε όλους τους καταλόγους PLAYMOBIL.

pronounce: plāy-mō-bēēl



1

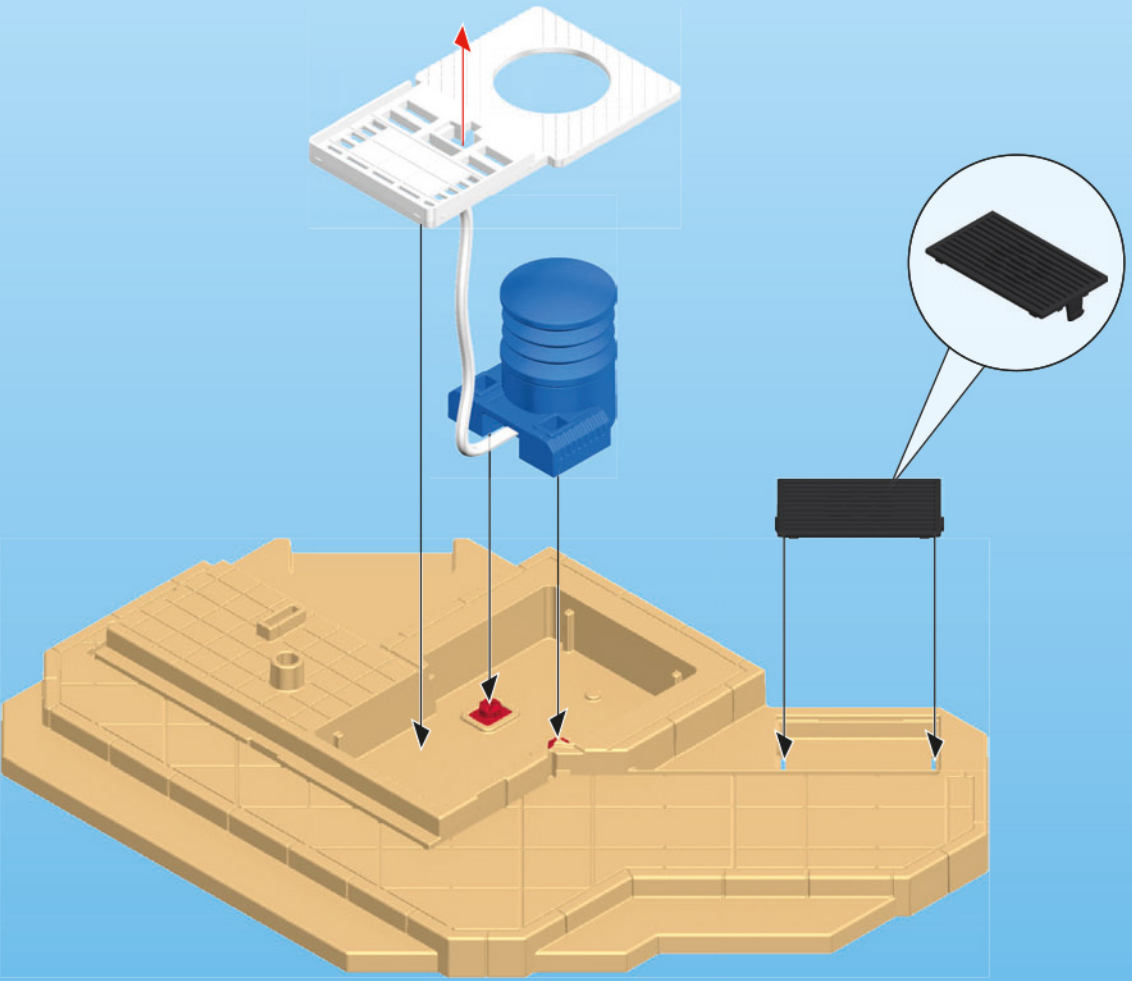
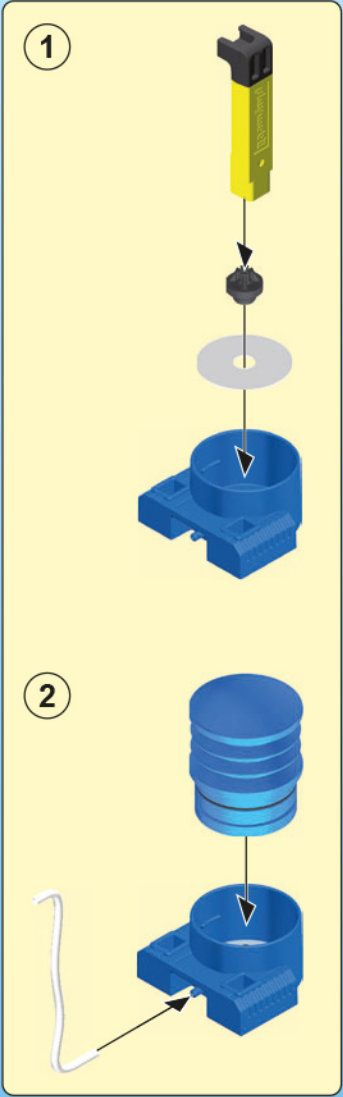

2

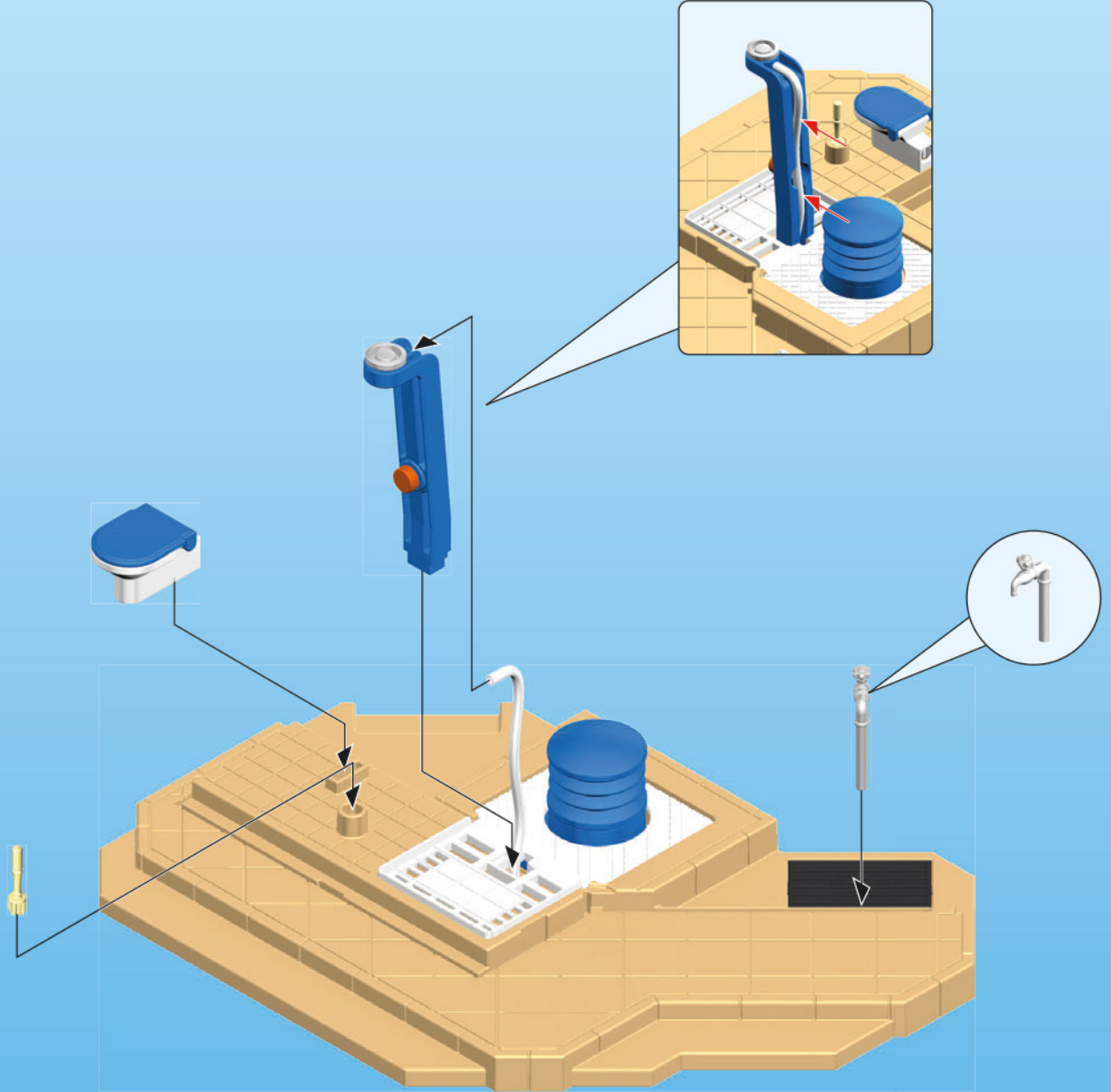
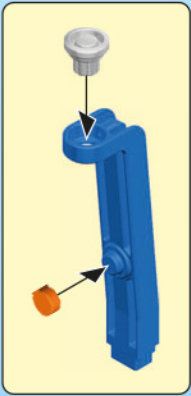

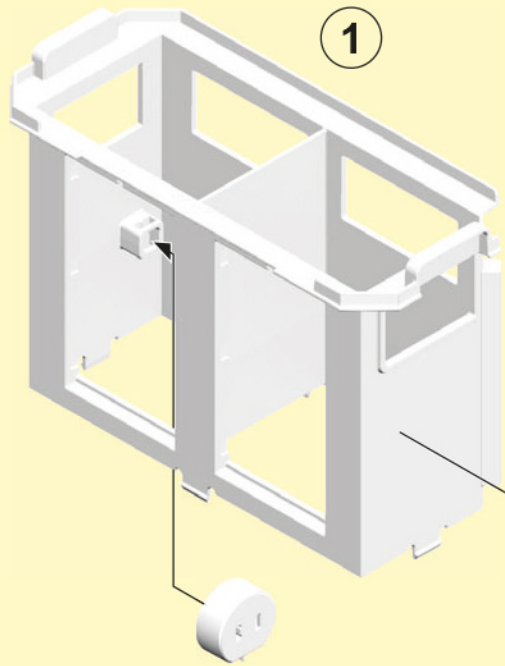

35



2

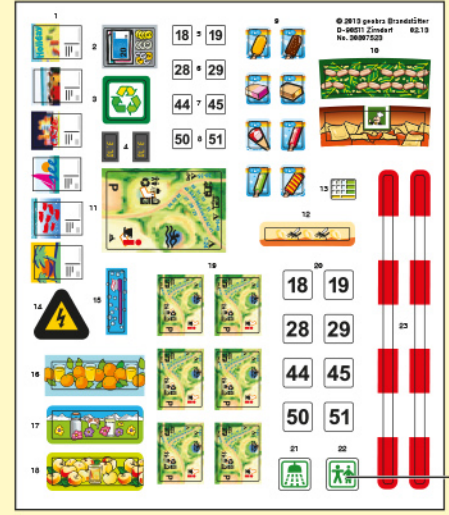

21

22



3

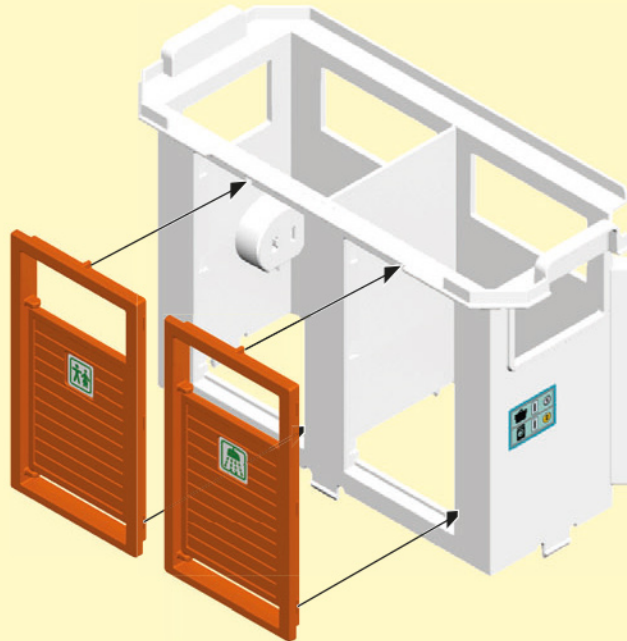
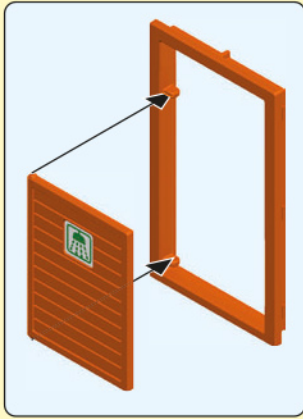
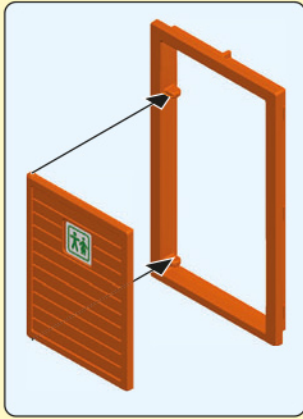

30



3

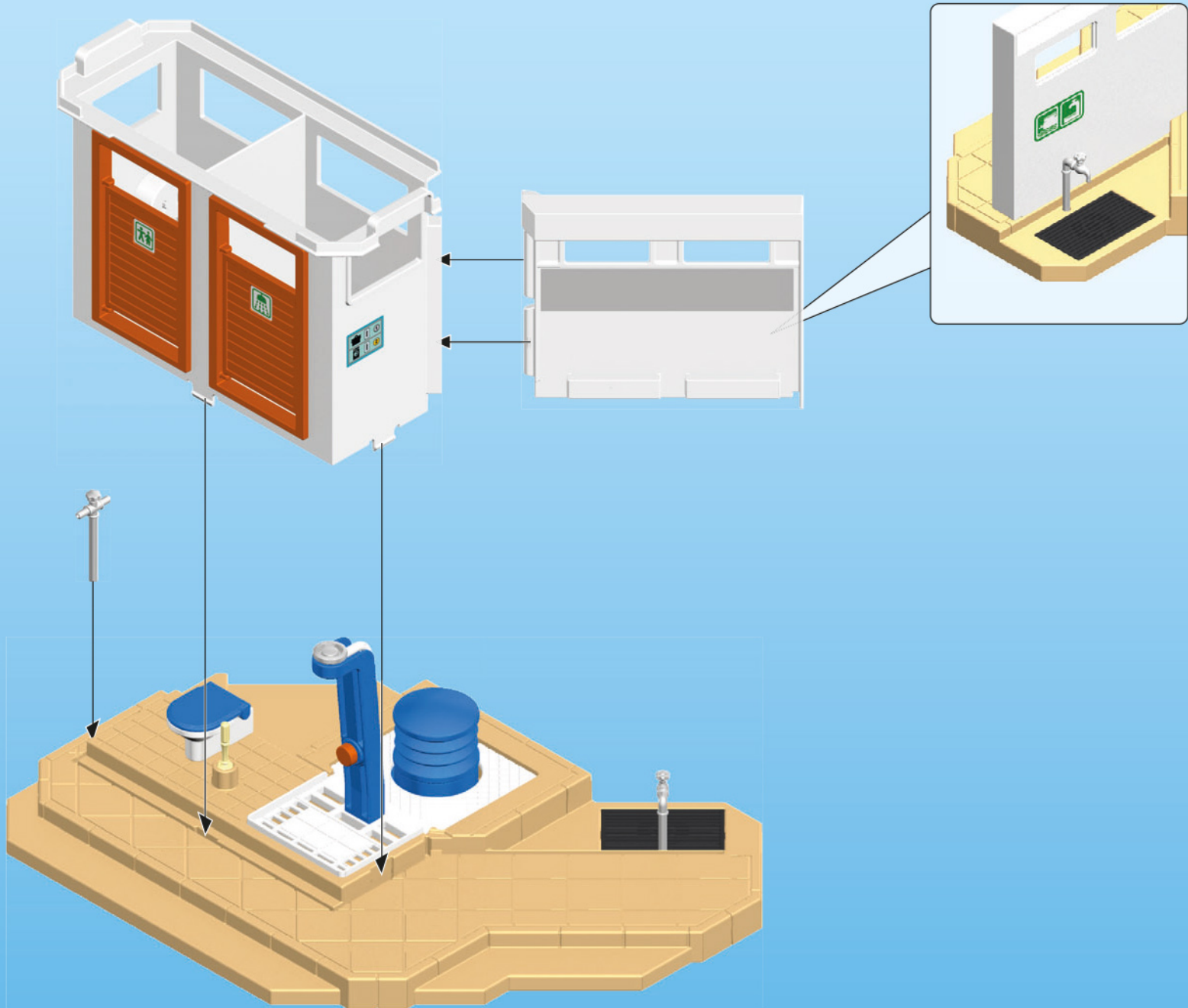

5

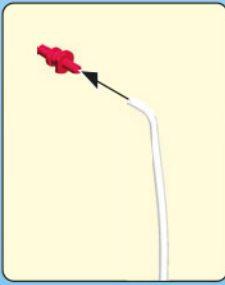
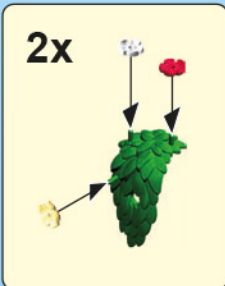
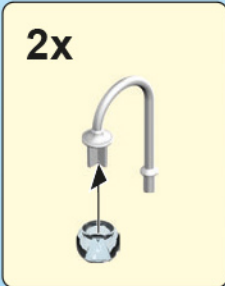

6

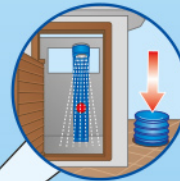

(D A CH L B) ACHTUNG! Nicht auf Augen oder Gesicht zielen. Nur Trinkwasser verwenden. Nach dem Spielen austrocknen lassen.

(USA GB CDN M IRL) WARNING! Do not aim at eyes or face. Use only tap water. Dry thoroughly after play.

(F CDN B L CH) ATTENTION! Ne pas viser les yeux ou le visage. N'utiliser que de l'eau potable. Faire sécher après chaque utilisation.

(E MEX) ATENCIÓN. No apuntar a los ojos ni a la cara. Utilizar solamente agua potable. Dejar secar antes de guardar.

(NL B) LET OP. Niet op ogen of gezicht richten. Enkel drinkbaar water gebruiken. Na het spelen laten drogen.

(I CH) ATTENZIONE! Non mirare agli occhi o al viso. Usare solo acqua potabile. Asciugare bene dopo ogni uso.

(P) AVISO! Não apontar para os olhos ou face. Utilizar somente água potável. Deixar secar antes de guardar.

(DK) ADVARSEL! Sigst ikke mod øjne eller ansigt. Anvend kun drikkevand. Lad det tørre ud når du er færdig med at lege.

(N) ADVARSEL! Sikt ikke på ansikt eller øyne. Kun drikkevann skal benyttes. Tørk opp etter at leken er ferdig.

(S FIN) VOBSERVERA. Sikta inte mot ögon eller ansikte. Använd endast dricksvatten. Låt torka efter användandet.

(FIN) HUOMIO. Ei saa kohdistaa suoraan silmiin tai kasvoihin. Käytä ainoastaan juomavettä. Anna kuivua leikin jälkeen.

(H) FIGYELMEZTETÉS. Tilos szemre vagy arcra célozni. Kérjük kizárólag ivóvizet használnjon! Játék után ajánlott a termék kiszáritása!

(CZ) VAROVÁNÍ! Nemířte na oči nebo na obličej! Používat jen pitnou vodu. Po hraní nechat vyschnout.

(EST) HOIATUS! Ära sihi silmadesse ega näkku. Kasutada üksnes joogivett! Mängimise järel kuivatada!

(LV) BRĪDINĀJUMS! Nevērst pret acīm vai seju. Izmantot tikai dzeramo ūdeni. Pēc spēlēšanās ļaut nožūt.

(LT) DĖMESIO! Netaikyti į akis arba veidą. Naudokite tik geriamąjį vandenį. Pažaidus, išdžiovinkite.

(SLO) OPOZORILO! Ne merite v oči ali obraz. V igračo vlivajte le pitno vodo. Po igri naj se igrača posuši.

(SK) UPOZORNENIE! Nemieriť do očí alebo do tváre. Používať iba pitnú vodu. Po hre nechať vyschnúť.

(PL) UWAGA! Nie celować w oczy i twarz. Używaj tylko wodę pitną. Po zabawie pozostaw do wyschnięcia.

(TR CY) UYARI! Göze veya yüze doğru tutmayınız. Sadece içme suyu kullanınız. Oyundan sonra kurumaya bırakın.

(GR CY) ΠΡΟΣΟΧΗ. Μη μνη γίνεται στόχευση στα μάτια ή στο πρόσωπο. Χρησιμοποιείστε μόνο νερό βρύσης. Μόλις τελειώσετε, αφήστε το παιχνίδι να στεγνώσει εντελώς.

(RO) AVERTIZARE! Nu se țintește în ochi sau în față. Se folosește doar apă potabilă. După joacă se lasă să se usuce.

(BG) ПРЕДУПРЕЖДЕНИЕ! Не насочвайте към очите и лицето. Използвайте само питейна вода. След игра оставете да изсъхне.

(CN) 警告! 请勿瞄准眼睛或脸。仅使用饮用水。玩耍后要干燥。

1

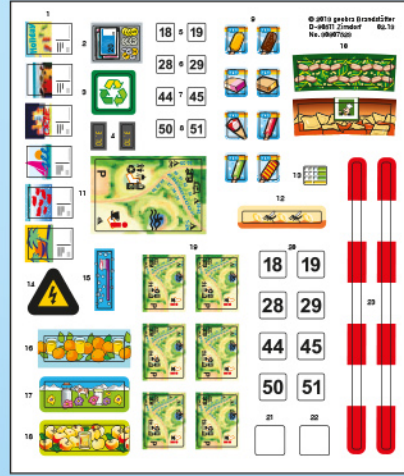

2

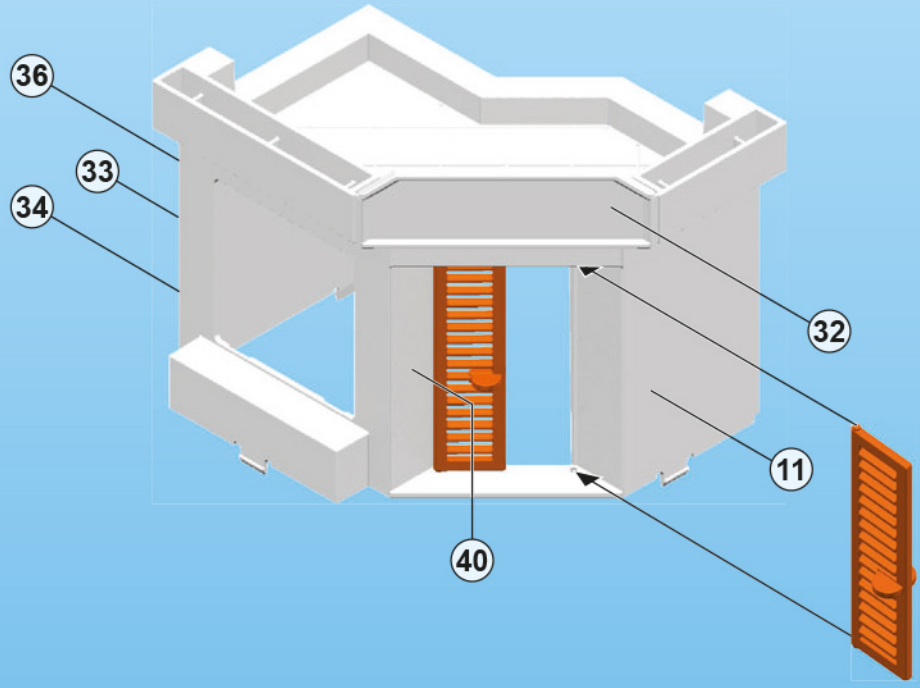
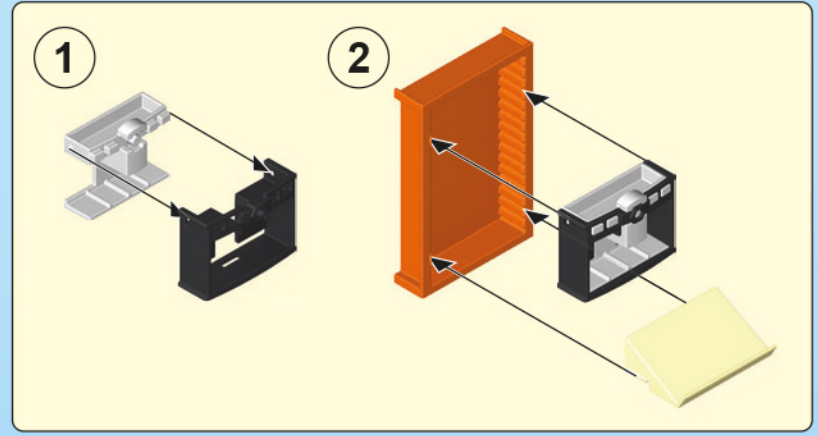

3

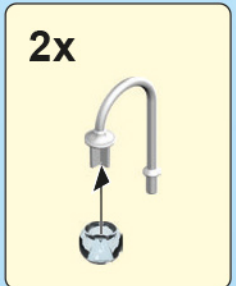
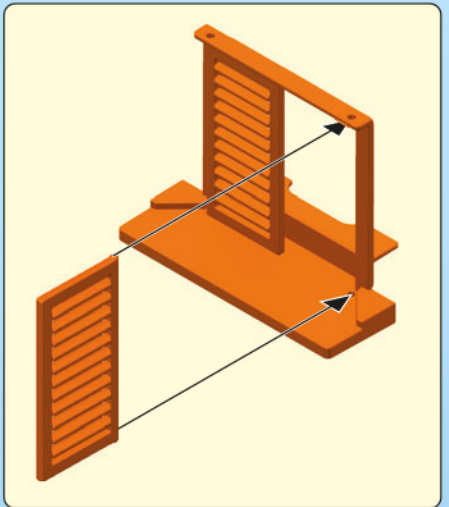

4

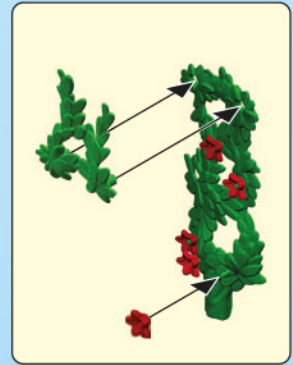
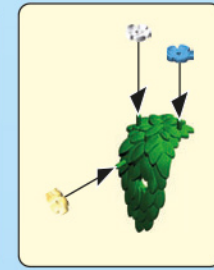
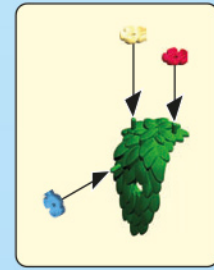
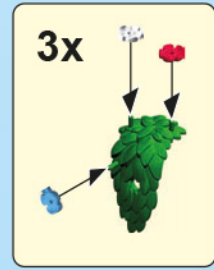

1

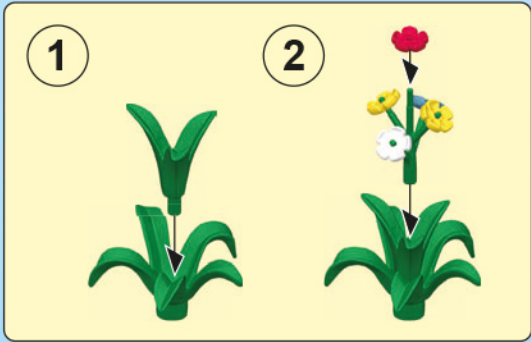

2

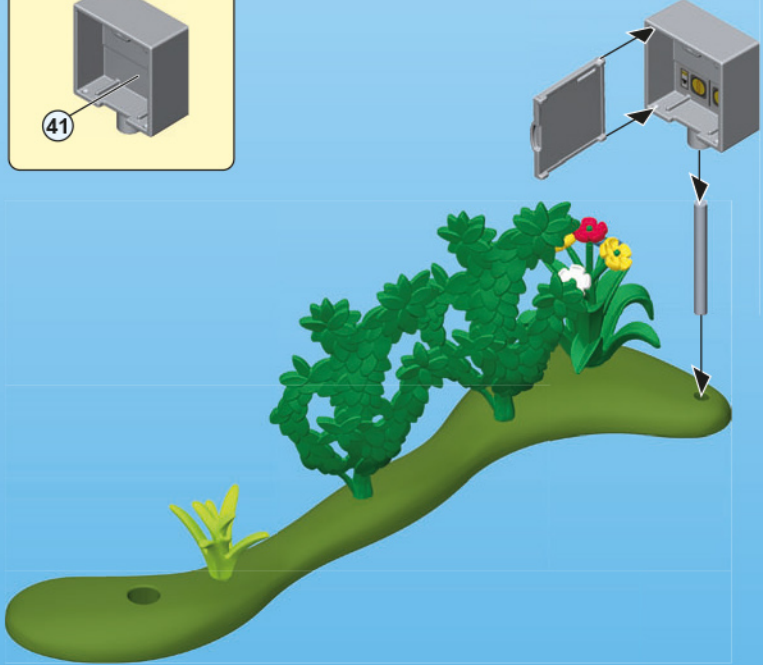
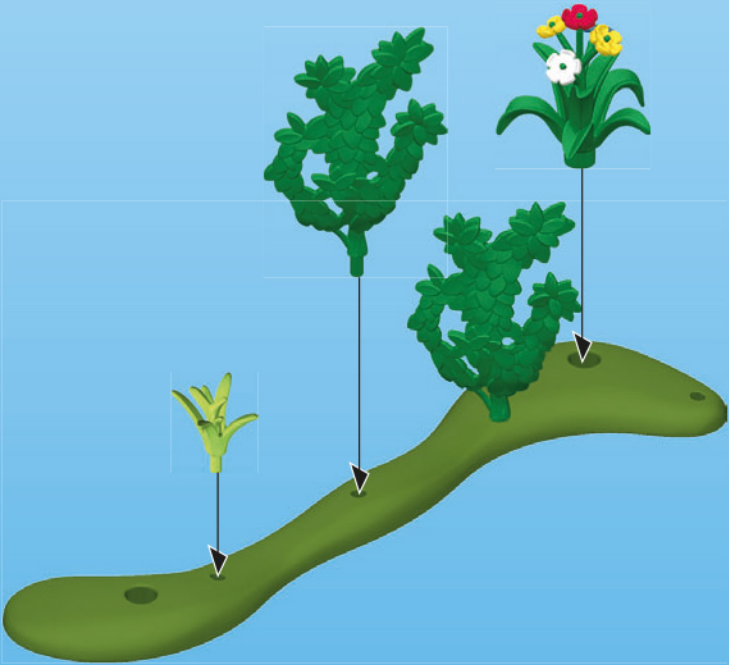
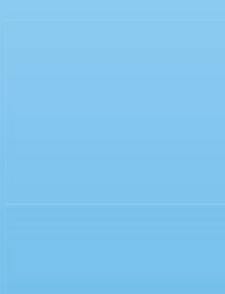
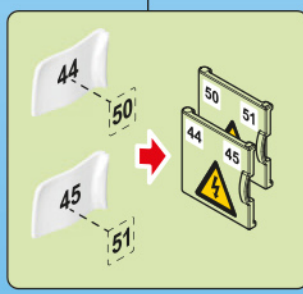
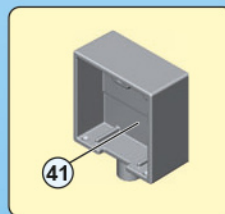
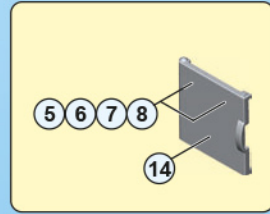
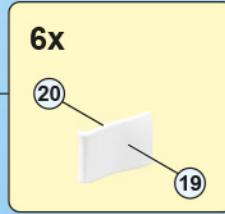
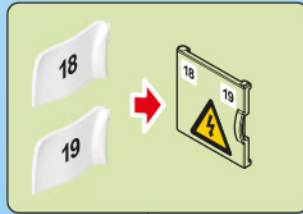
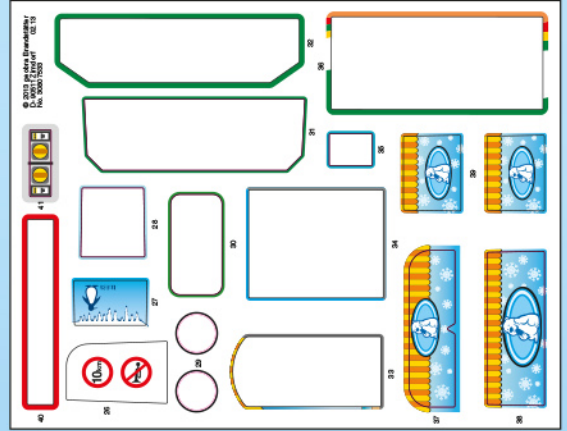
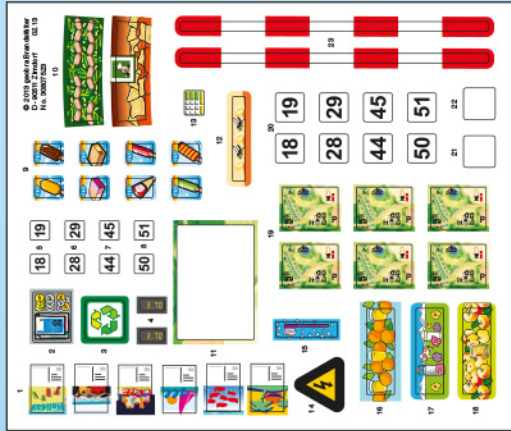

3

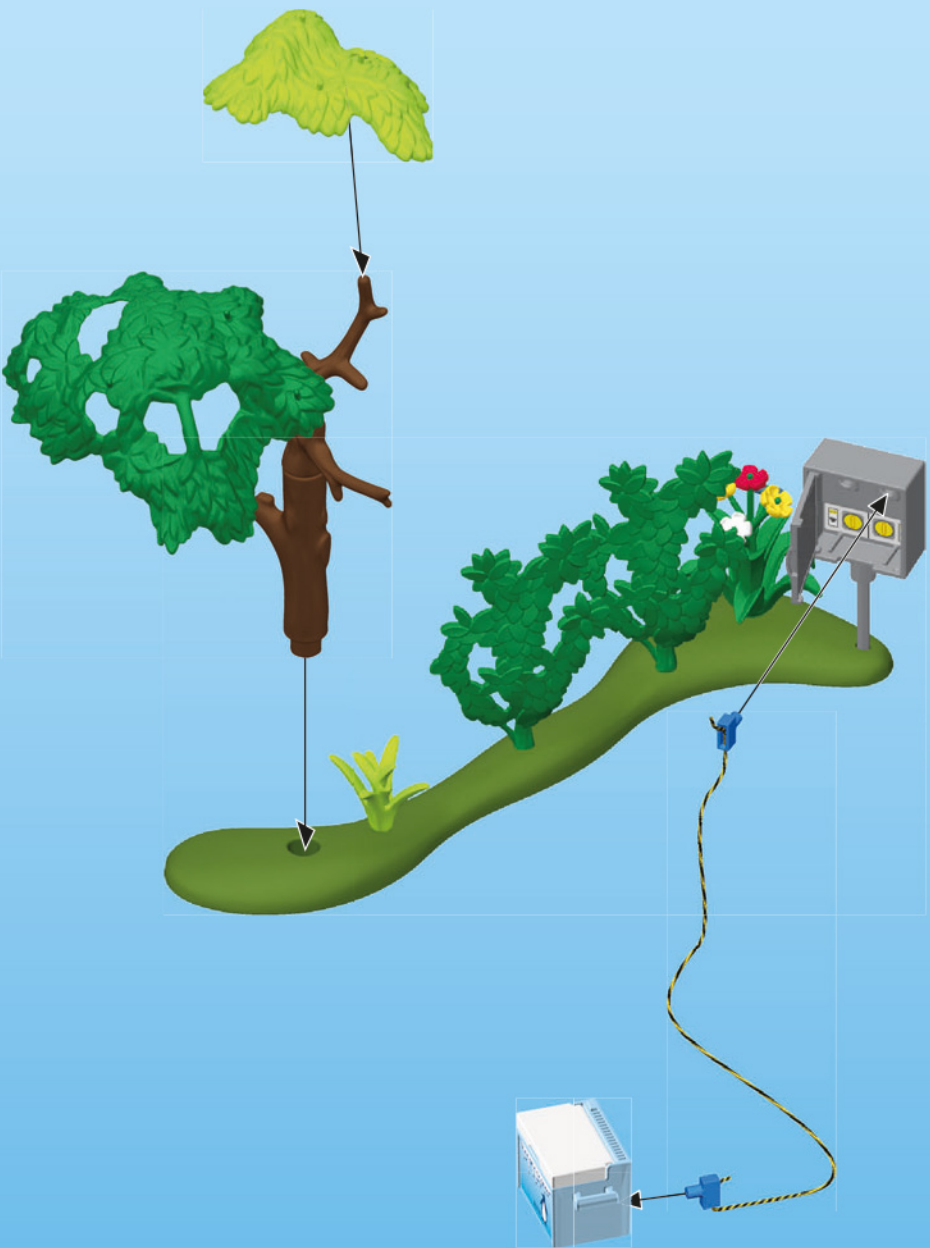
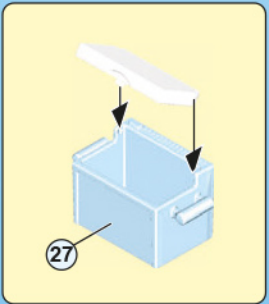
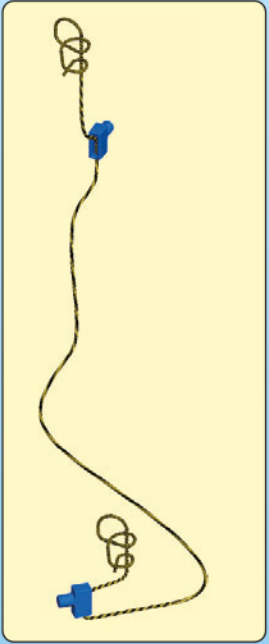

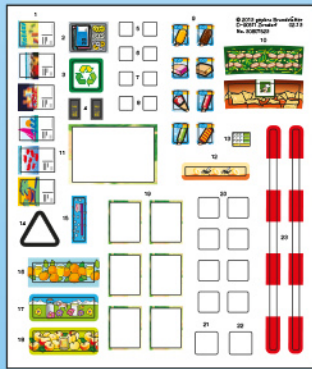
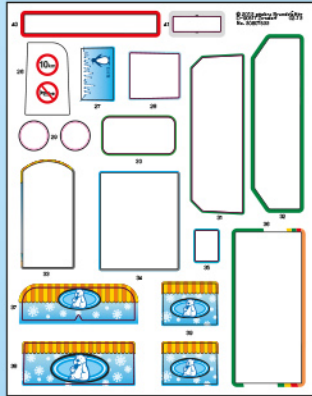

1

30 61 0112

30 25 1543

30 61 0112

2

30 25 1533

30 25 1523

30 21 6010

30 21 6020

30 21 6000

1

4

13

2

30 26 7400

30 26 7410

2

30 23 1310

30 25 3170

30 22 7110

15

9

8x

30 23 1330

30 20 7503

30 23 1300

30 22 5950

30 22 5800

6x

30 24 8052

1

1

30 25 1473

37

39

38

30 25 1483

2

30 25 1493

30 80 7543

30 51 0062

30 51 0072

30 25 1453

30 22 5900

1

2x
30 25 2810

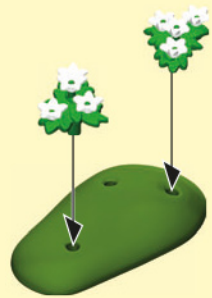
30 03 2920

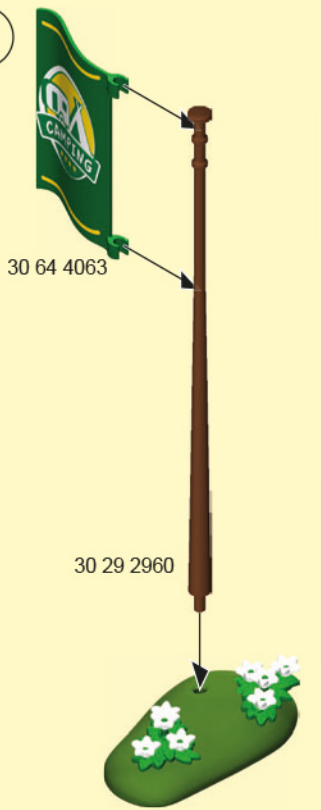

30 09 2090

2

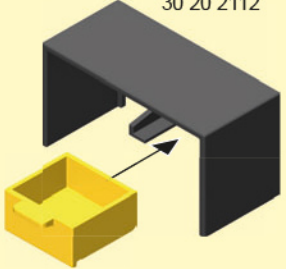

30 29 2960

30 20 2112

30 25 1463

30 03 2370

30 03 2380

30 62 7212
30 23 5440

30 23 8910
30 21 9930



30 02 4190



30 00 2673
30 60 0612



30 14 6330



30 25 1393
30 10 3110



30 46 9860

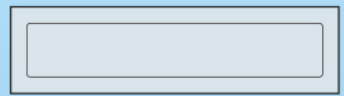

30 80 7553



30 80 9323

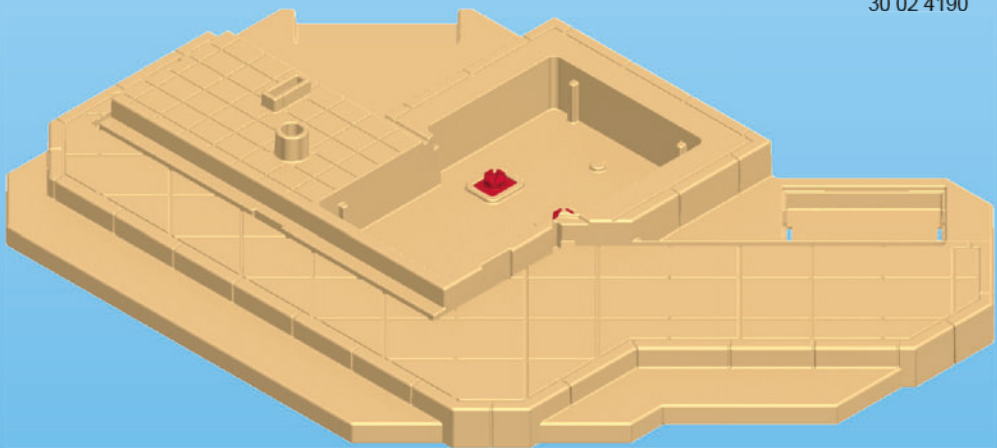

30 51 2842

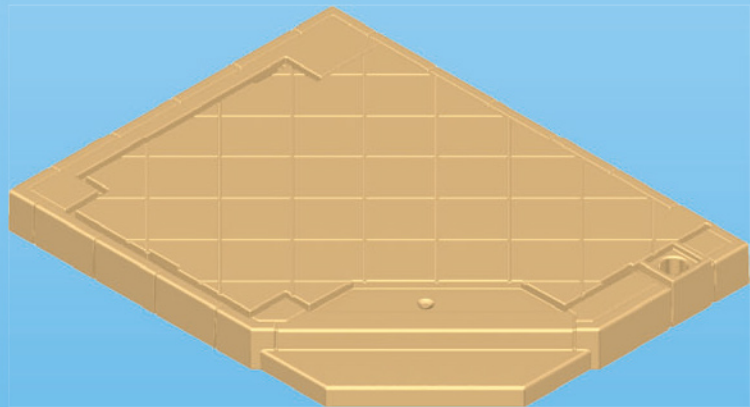

30 25 1583

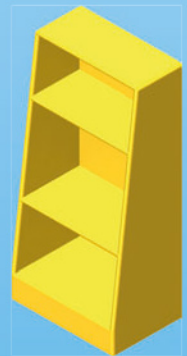

30 25 1443

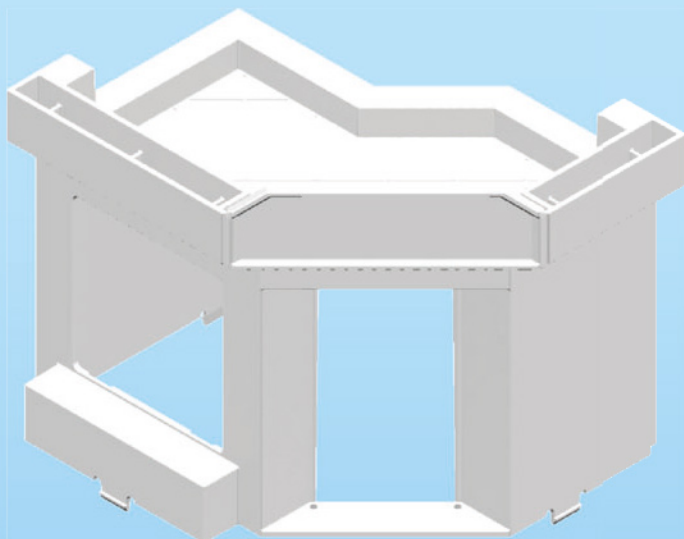

30 25 1593

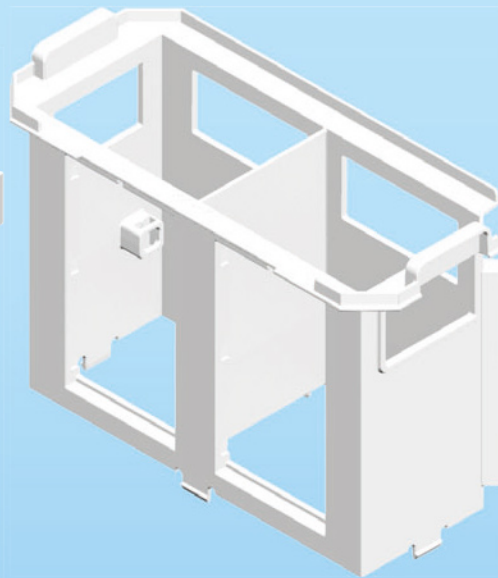

30 25 1683



30 80 7533

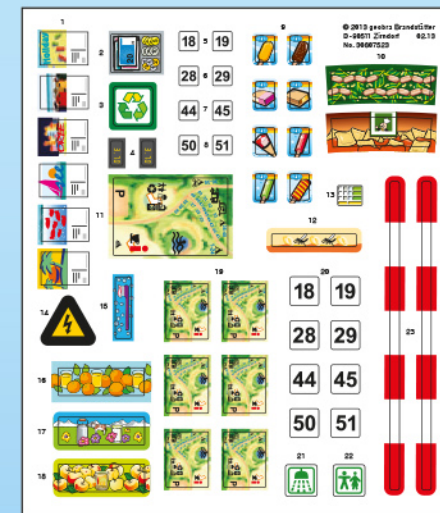

30 80 7523

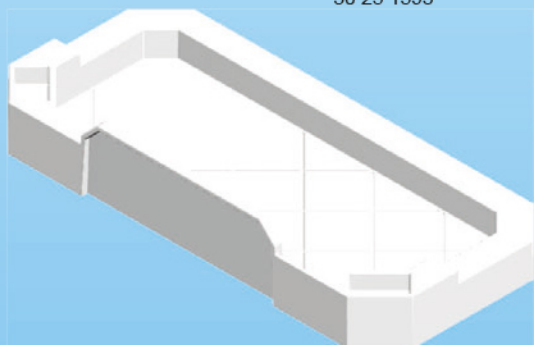

30 46 0032

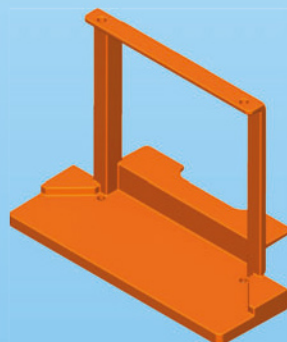

30 25 1603



2x 30 25 1693



30 64 4133



30 21 1542

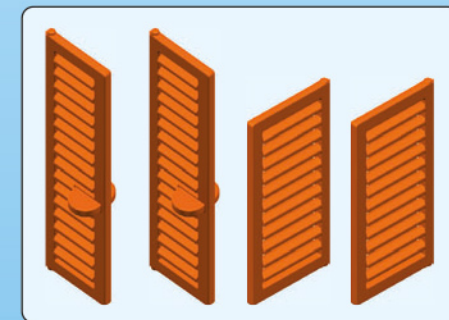

30 51 2192



30 25 2053



30 89 5442



30 09 6830



30 28 4430



30 63 5372



30 20 5060



30 51 3880



3x 30 04 2760



30 25 1403



30 25 0143



30 25 1642



30 63 6082

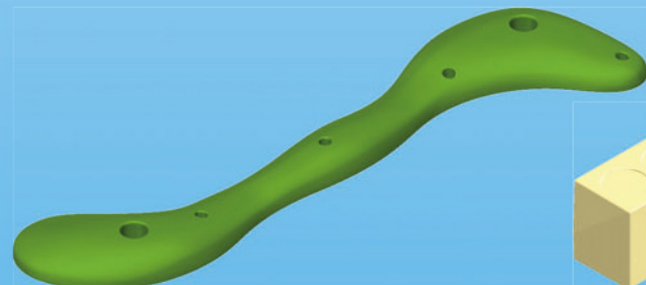

30 25 0003

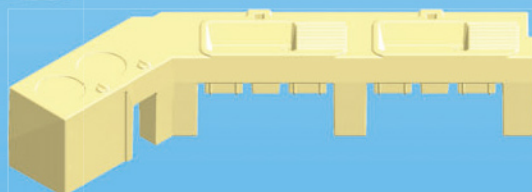

30 25 1713



30 25 1573



30 28 8830



2x 30 25 1703

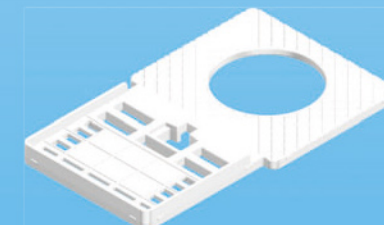

30 25 1673



30 20 5260



2x 30 25 1513



30 24 1130



30 88 8852

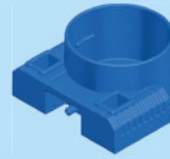

30 27 9940

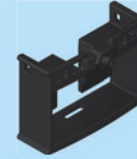

30 25 2142

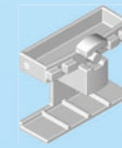

30 25 2132



30 60 1192



2x 30 21 1302



30 23 1050



30 21 4972

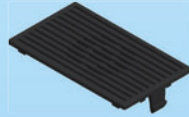

30 21 4662



30 02 4260



30 29 9740



30 25 9003



7x 30 21 4422



30 73 2212



30 02 6540

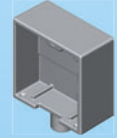

30 25 0033



30 25 1433



30 24 3830



4x 30 21 4742



2x 30 21 0153



4x 30 25 1553



30 04 2980



30 20 4700



30 63 5220



30 25 1733



30 25 0023



30 25 0013



30 25 0083



30 25 1633



30 25 1643



30 20 4710



30 25 1723



30 89 3852



2x 30 80 8313



6x 30 08 3920



30 80 6823



2x 30 25 1653



30 20 4720



30 60 6610



30 25 0073



30 25 1413



30 25 2063



30 09 5540



2x 30 25 1623



4x 30 25 1563



2x 30 25 0133



30 26 8730



30 29 1770



4x 30 25 1423



4x 30 25 0113



30 28 1950



7x 30 09 4659



7x 30 25 1280



7x 30 09 5209



7x 30 05 9729



9x 30 25 2820



30 89 4940



30 25 2073



30 23 0460



2x 30 25 0043